



9.5 CAPOSALDI E CORRIMANI

- 9.5 CAPOSALDI PER SCALE
- 9.6 CORRIMANI E MARTELLATI
- 9.7 POMOLI FORGIATI
- 9.8 PIASTRINE
- 9.9 ORNAMENTI PER CANCELLI

9.5 END POSTS AND HANDRAILS

- 9.5 END POSTS FOR STAIRCASES
- 9.6 HANDRAILS AND HAMMERED BARS AND TUBES
- 9.7 FORGED KNOBS
- 9.8 PLATES
- 9.9 GATES ORNAMENTS

9.5

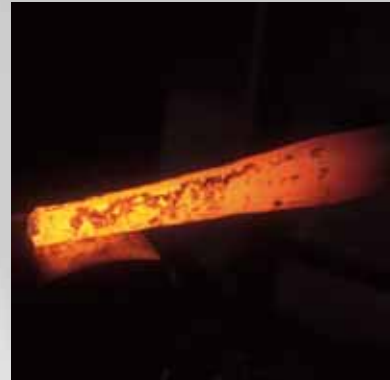

Finitura caposaldi (art. 9600)
End posts finishing (art. 9600)

Esecuzione allargatura partenze per corrimani
Handrails terminals widening

Esecuzione rastrematura partenze per accoppiare corrimano a caposaldo
Terminals tapering for matching handrail with the corresponding end post

LAMINATO A CALDO - HOT ROLLING

HEISS GEWALTSTES METALL - LAMINADO EN CALIENTE - LAMINE A CHAUD

É un'operazione di deformazione plastica (permanente), dove il ferro caldo, passando attraverso una successione di rulli assume la forma del profilo dei rulli stessi. Il ferro laminato a caldo è riconoscibile in quanto la sua superficie presenta uno strato di colore scuro (calamina) che protegge il ferro dalla ruggine.

It is a permanent plastic deformation process.

The hot iron passes through a series of rolls and gets the shape of the rolls themselves.

Cold rolled iron is characterised on its surface by a dark membrane called "calamine" which protects the iron from the rust.

Es handelt sich um einen dauerhaften plastischen Verformungsvorgang, bei dem das heisse Eisen durch eine Rollenserie geführt wird, und die Form der Profilen der Rollen annimmt. Das heissgewalzte Metall erkennt man an seiner dunkelfarbigen Oberfläche (Zunder) das es vor Rost schützt.

Es una operación de deformación plástica (permanente), donde el hierro caliente, pasando a través de una sucesión de rolos, toma la forma del perfil de los rolos mismos.

El hierro laminado en caliente puede ser reconocido en cuanto su superficie presenta una tela oscura (calamina) que protege el hierro del rojizo.

C'est un procédé de déformation plastique permanente pendant lequel le fer chaud, en passant à travers une succession de rouleaux, prend la forme du profil des rouleaux mêmes. On peut reconnaître le fer laminé à chaud pour une couche sur sa surface couleur foncée (calamine) qui protège le fer contre la rouille.

CAPOSALDI E CORRIMANI

END POSTS AND HANDRAILS

9.5

Artifer®

particolari che fanno la differenza • details which make the difference



particolari che fanno la differenza • details which make the difference

9,5

⚒ *Martellato*
Hammered

🔥 *Rifinito a caldo*
Hot finished

✋ *Forigato a mano*
Hand forged

Particolare finitura
Finish detail



mm 1200 h 47-1/4" h

9500 ■ 20 3/4"
9502 ■ 30 1-3/16"

mm 1200 h 47-1/4" h

9503 ◀ ■ 30 1-3/16"

mm 1200 h 47-1/4" h

9505 ■ 25 1"
9506 ■ 30 1-3/16"

mm 1200 h 47-1/4" h

9508 ◀ ■ 25 1"

mm 1200 h 47-1/4" h

9510 ■ 25 1"
9511 ■ 30 1-3/16"

■ *Ferro pieno quadro*
Square iron

■ *Ferro pieno piatto*
Flat iron

● *Ferro pieno tondo*
Round iron

9.5



mm 1200 h 47-1/4" h
9512-031 ☞ ■ 25 1"

mm 1200 h 47-1/4" h
9515 ☞ ■ 25 1"

mm 1200 h 47-1/4" h
9517 ☞ ● 25 1"
9518 ☞ ● 30 1-3/16"

mm 1200 h 47-1/4" h
9520 ☞ ■ 25 1"
9521 ☞ ■ 30 1-3/16"

mm 1200 h 47-1/4" h
9523-052 ■ 30 1-3/16"

 *Martellato*
Hammered

 *Rifinito a caldo*
Hot finished

 *Forigato a mano*
Hand forged

Particolare finitura
Finish detail



mm 1200 h 47-1/4" h

9570  ■ 25 1"
9572  ■ 30 1-3/16"

mm 1200 h 47-1/4" h

9575  ■ 25 1"

mm 1200 h 47-1/4" h

9576  ■ 25 1"

mm 1200 h 47-1/4" h

9577  ■ 25 1"

mm 1200 h 47-1/4" h

9578-031  ■ 25 1"
9578-032  ■ 30 1-3/16"

■ *Ferro pieno quadro*
Square iron

■ *Ferro pieno piatto*
Flat iron

● *Ferro pieno tondo*
Round iron

9.5



mm 1200 h 47-1/4" h

9580 ■ 25 1"
9580-032 ■ 30 1-3/16"

mm 1200 h 47-1/4" h

9588 ■ 25 1"

mm 1200 h 47-1/4" h

9589 ● 30 1-3/16"

mm 1200 h 47-1/4" h

9590 ■ 25 1"
9590-032 ■ 30 1-3/16"

mm 1200 h 47-1/4" h

9591-051 ● 25 1"

 *Martellato*
Hammered

 *Rifinito a caldo*
Hot finished

 *Forigato a mano*
Hand forged

Particolare finitura
Finish detail



mm 1200 h 47-1/4" h

9596  ● 25 1"

mm 1200 h 47-1/4" h

9597  ● 30 1-3/16"

mm 1200 h 47-1/4" h

9598  ● 25 1"

mm 1200 h 47-1/4" h

9599  ● 25 1"

mm 1200 h 47-1/4" h

9600  ■ 25 1"

■ Ferro pieno quadro
Square iron

■ Ferro pieno piatto
Flat iron

● Ferro pieno tondo
Round iron



■ 40 x 8 1-5/8" x 5/16"

9525 3000 h 118" h
9525 6M 6000 h 236" h



mm 140 x 250 h 5-1/2" x 10" h

9620 ■ 40 x 8 1-5/8" x 3/16"



mm 240 x 350 h 9-1/2" x 13-3/4" h

9630 ■ 40 x 8 1-5/8" x 3/16"



mm 200 x 450 h 8" x 17-3/4" h

9640 ■ 40 x 8 1-5/8" x 3/16"

CORRIMANI E PIATTI MARTELLATI
HANDRAILS AND HAMMERED FLAT BARS 9.6

 *Martellato*
Hammered

 *Rifinito a caldo*
Hot finished

 *Forigato a mano*
Hand forged

Particolare finitura
Finish detail

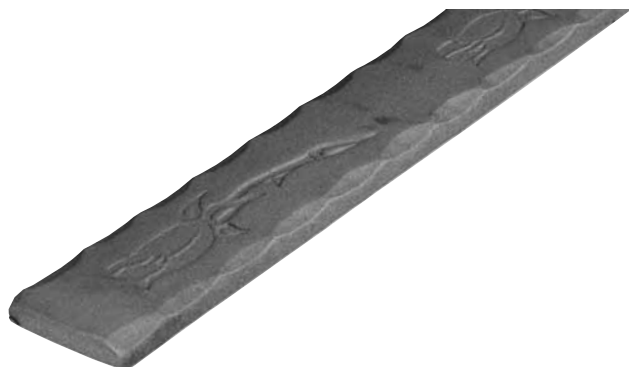

■ 40 x 8 *1-5/8" x 5/16"*

9526	3000 h	<i>118" h</i>
9526 6M	6000 h	<i>236" h</i>



mm 140 x 250 h *5-1/2" x 10" h*

P1 9526	■ 40 x 8	<i>1-5/8" x 3/16"</i>
----------------	----------	-----------------------



mm 240 x 350 h *9-1/2" x 13-3/4" h*

P2 9526	■ 40 x 8	<i>1-5/8" x 3/16"</i>
----------------	----------	-----------------------



mm 200 x 450 h *8" x 17-3/4" h*

P3 9526	■ 40 x 8	<i>1-5/8" x 3/16"</i>
----------------	----------	-----------------------

9.6

■ Ferro pieno quadro
Square iron

■ Ferro pieno piatto
Flat iron

● Ferro pieno tondo
Round iron

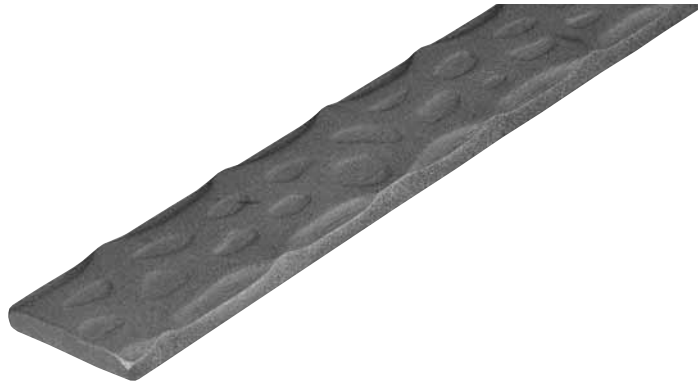

■ 40 x 8 1-5/8" x 5/16"

9527 3000 h 118" h
9527 6M 6000 h 236" h

mm 140 x 250 h 5-1/2" x 10" h

P1 9527 ■ 40 x 8 1-5/8" x 5/16"



mm 240 x 350 h 9-1/2" x 13-3/4" h

P2 9527 ■ 40 x 8 1-5/8" x 3/16"

mm 200 x 450 h 8" x 17-3/4" h

P3 9527 ■ 40 x 8 1-5/8" x 3/16"

CORRIMANI E PIATTI MARTELLATI
HANDRAILS AND HAMMERED FLAT BARS 9,6

 *Martellato*
Hammered

 *Rifinito a caldo*
Hot finished

 *Forigato a mano*
Hand forged

Particolare finitura
Finish detail



■ 40 x 8 1-5/8" x 5/16"
9529 3000 h 118" h
9529 6M 6000 h 236" h



mm 140 x 250 h 5-1/2" x 9-7/8" h
P1 9529 ■ 40 x 8 1-5/8" x 3/16"



mm 240 x 350 h - 9-1/2" x 13-3/4" h
P2 9529 ■ 40 x 8 1-5/8" x 5/16"



mm 200 x 450 h - 7-7/8" x 17-3/4" h
P3 9529 ■ 40 x 8 1-5/8" x 5/16"

9.6

■ Ferro pieno quadro
Square iron

■ Ferro pieno piatto
Flat iron

● Ferro pieno tondo
Round iron



■ 40 x 8 1-5/8" x 5/16"

9530 3000 h 118" h
9530 6M 6000 h 236" h

mm 140 x 250 h 5-1/2" x 9-7/8" h

9621 ■ 40 x 8 1-5/8" x 3/16"



mm 240 x 350 h 9-1/2" x 13-3/4" h

9631 ■ 40 x 8 1-5/8" x 5/16"



mm 200 x 450 h 7-7/8" x 17-3/4" h

9641 ■ 40 x 8 1-5/8" x 5/16"

 *Martellato*
Hammered

 *Rifinito a caldo*
Hot finished

 *Forigato a mano*
Hand forged

Particolare finitura
Finish detail

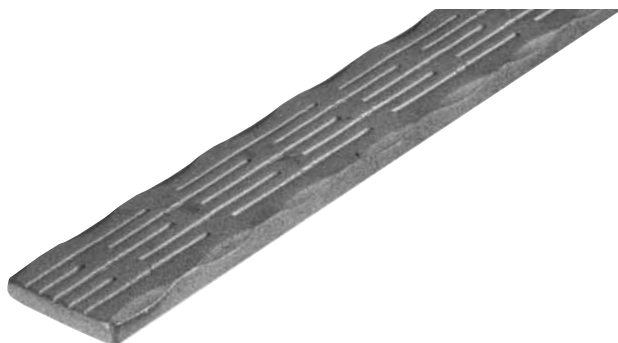

■ 40 x 8 *1-5/8" x 5/16"*

9531	3000 h	<i>118" h</i>
9531 6M	6000 h	<i>236" h</i>



mm 140 x 250 h *5-1/2" x 10" h*

P1 9531	■ 40 x 8	<i>1-5/8" x 5/16"</i>
----------------	----------	-----------------------



mm 240 x 350 h *9-1/2" x 13-3/4" h*

P2 9531	■ 40 x 8	<i>1-5/8" x 5/16"</i>
----------------	----------	-----------------------



mm 200 x 450 h *8" x 17-3/4" h*

P3 9531	■ 40 x 8	<i>1-5/8" x 5/16"</i>
----------------	----------	-----------------------

■ Ferro pieno quadro
Square iron

■ Ferro pieno piatto
Flat iron

● Ferro pieno tondo
Round iron

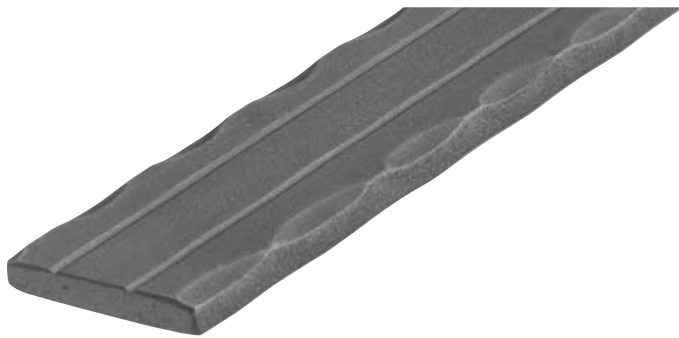

■ 50 x 10 2" x 3/8"

9531-191 3000 h 118" h
9531-191 6M 6000 h 236" h



mm 150 x 250 h 5-7/8" x 10" h

P1 9531-191 ■ 50 x 10 2" x 3/8"



mm 260 x 350 h 10-1/4" x 13-3/4" h

P2 9531-191 ■ 50 x 10 2" x 3/8"



mm 200 x 450 h 8" x 17-3/4" h

P3 9531-191 ■ 50 x 10 2" x 3/8"

 *Martellato*
Hammered

 *Rifinito a caldo*
Hot finished

 *Forigato a mano*
Hand forged

Particolare finitura
Finish detail

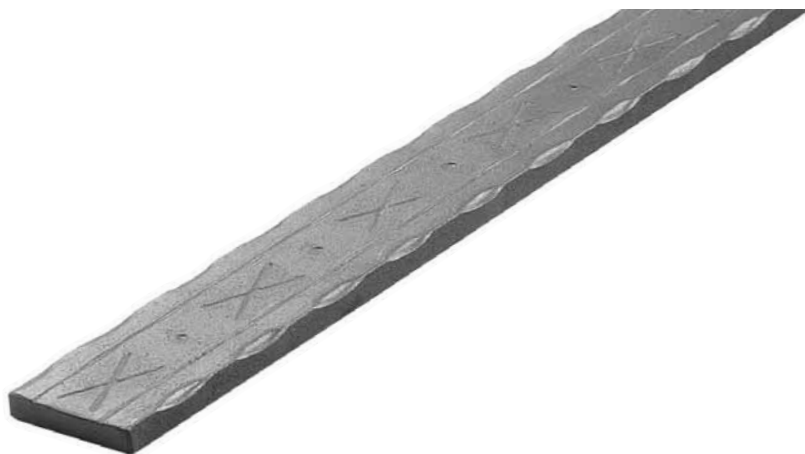

	40 x 8	1-5/8" x 5/16"
9535	3000 h	118" h
9535 6M	6000 h	236" h



	mm 140 x 250 h	5-1/2" x 10" h
9622	40 x 8	1-5/8" x 5/16"



	mm 240 x 350 h	9-1/2" x 13-3/4" h
9632	40 x 8	1-5/8" x 5/16"



	mm 200 x 450 h	8" x 17-3/4" h
9642	40 x 8	1-5/8" x 5/16"

■ Ferro pieno quadro
Square iron

■ Ferro pieno piatto
Flat iron

● Ferro pieno tondo
Round iron

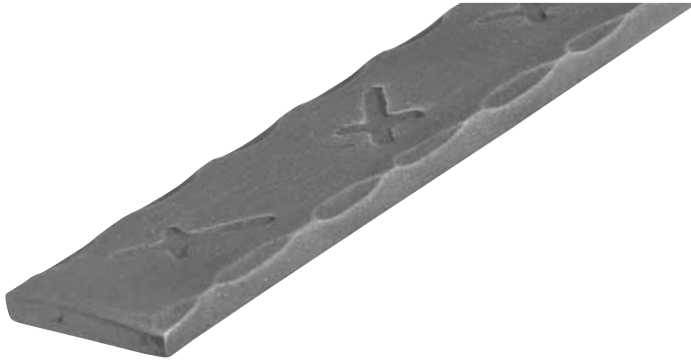

■ 40 x 8 1-5/8" x 5/16"

9535-187 3000 h 118" h
9535-187 6M 6000 h 236" h



mm 140 x 250 h 5-1/2" x 10" h

P1 9535-187 ■ 40 x 8 1-5/8" x 5/16"



mm 240 x 350 h 9-1/2" x 13-3/4" h

P2 9535-187 ■ 40 x 8 1-5/8" x 5/16"



mm 200 x 450 h 8" x 17-3/4" h

P3 9535-187 ■ 40 x 8 1-5/8" x 5/16"

 **Martellato**
Hammered



 **Rifinito a caldo**
Hot finished

 **Forigato a mano**
Hand forged

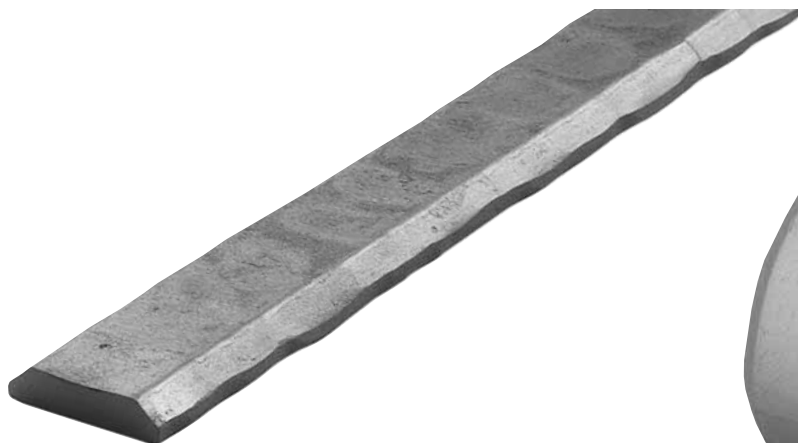
Particolare finitura
Finish detail





mm ca 2300 h 90" h

9605		40 x 15	1-5/8" x 5/8"
9606		50 x 15	2" x 5/8"





mm 140 x 250 h 5-1/2" x 10" h

9623		40 x 15	1-5/8" x 5/8"
9624		50 x 15	2" x 5/8"





mm 260 x 350 h 10-1/4" x 13-3/4" h

9633		40 x 15	1-5/8" x 5/8"
9634		50 x 15	2" x 5/8"





mm 250 x 450 h 10" x 17-3/4" h

9643		40 x 15	1-5/8" x 5/8"
9644		50 x 15	2" x 5/8"



mm 700 h 27-1/2" h

9785		40 x 15	1-5/8" x 5/8"
9786		50 x 15	2" x 5/8"

■ Ferro pieno quadro
Square iron

■ Ferro pieno piatto
Flat iron

● Ferro pieno tondo
Round iron



mm ca 2300 h 90" h

9610  ■ 58 x 14 2-1/4" x 9/16"



mm 150 x 250 h 6" x 10" h

9625  ■ 58 x 14 2-1/4" x 9/16"



mm 260 x 350 h 10-1/4" x 13-3/4" h

9635  ■ 58 x 14 2-1/4" x 9/16"



mm 260 x 500 h 10-1/4" x 19-5/8" h

9645  ■ 58 x 14 2-1/4" x 9/16"



mm 700 h 27-1/2" h

9787  ■ 58 x 14 2-1/4" x 9/16"

CORRIMANI E PIATTI MARTELLATI
HANDRAILS AND HAMMERED FLAT BARS 9.6

 **Martellato**
Hammered

 **Rifinito a caldo**
Hot finished

 **Forigato a mano**
Hand forged

Particolare finitura
Finish detail

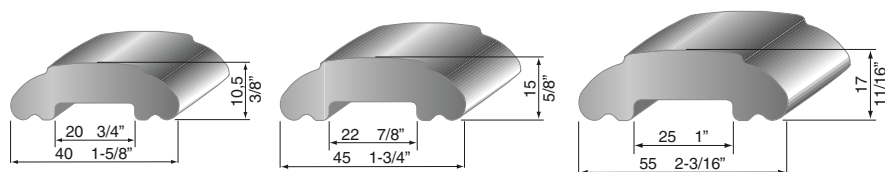

mm 3000 h 118" h

9611	■ 40 x 10,5	1-5/8" X 7/16"
9612	■ 45 x 15	1-3/4" X 5/8"
9613	■ 55 x 17	2-3/16" X 11/16"

mm 6000 h 236" h

9611 6M	■ 40 x 10,5	1-5/8" X 7/16"
9612 6M	■ 45 x 15	1-3/4" X 5/8"
9613 6M	■ 55 x 17	2-3/16" X 11/16"

mm 150 x 250 h 6"x 10" h

9740	■ 40 x 10,5	1-5/8" X 7/16"
9741	■ 45 x 15	1-3/4" X 5/8"
9742	■ 55 x 17	2-3/16" X 11/16"



mm 260 x 350 h 10-1/4"x 13-3/4" h

9750	■ 40 x 10,5	1-5/8" X 7/16"
9751	■ 45 x 15	1-3/4" X 5/8"
9752	■ 55 x 17	2-3/16" X 11/16"

mm 250 x 450 h 10"x 17-3/4" h

9760	■ 40 x 10,5	1-5/8" X 7/16"
9761	■ 45 x 15	1-3/4" X 5/8"
9762	■ 55 x 17	2-3/16" X 11/16"

9.6

■ **Ferro pieno quadro**
Square iron

■ **Ferro pieno piatto**
Flat iron

● **Ferro pieno tondo**
Round iron

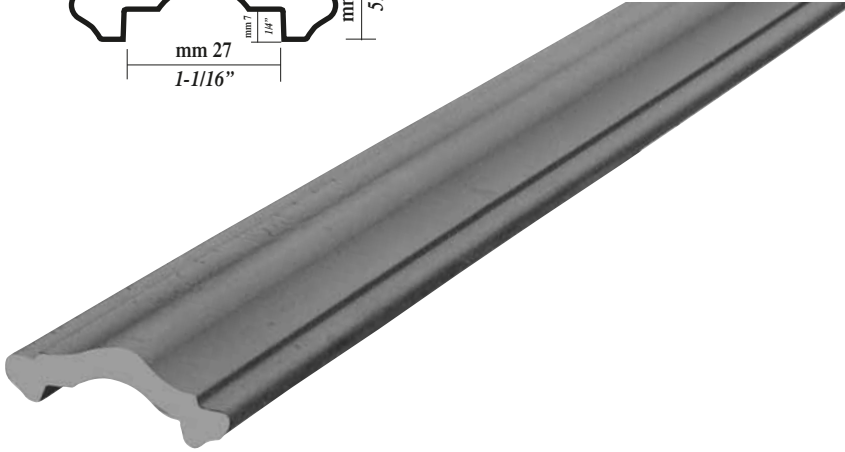
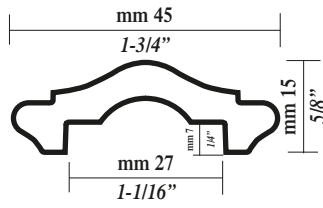

■ 45 x 15 1-3/4" x 5/8"

9614-089	3000 h	118" h
9614-089 6M	6000 h	236" h

mm 140 x 250 h 5-1/2" x 10" h

P1 9614-089 ■ 45 x 15 1-3/4" x 5/8"



mm 240 x 350 h 9-1/2" x 13-3/4" h

P2 9614-089 ■ 45 x 15 1-3/4" x 5/8"



mm 300 x 450 h 12" x 17-3/4" h

P3 9614-089 ■ 45 x 15 1-3/4" x 5/8"

 *Martellato*
Hammered

 *Rifinito a caldo*
Hot finished

 *Forigato a mano*
Hand forged

Particolare finitura
Finish detail

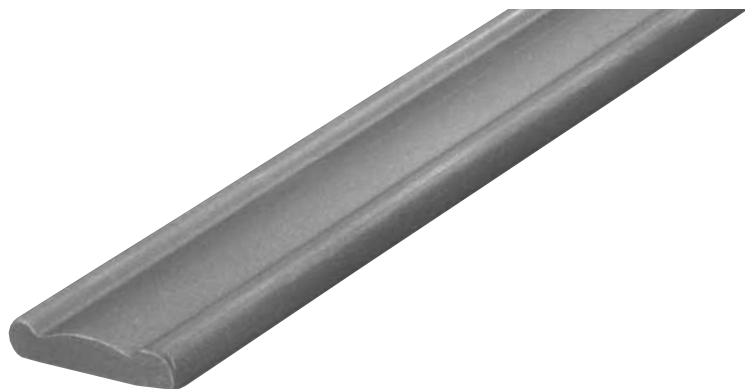

	mm 3000 h	118" h
9615	■ 40 x 8	1-5/8" x 5/16"
9616	■ 50 x 10	2" x 3/8"

	mm 6000 h	236" h
9615-6M	■ 40 x 8	1-5/8" x 5/16"
9616-6M	■ 50 x 10	2" x 3/8"



	mm 130 x 250 h	5-1/8" x 10" h
9626	■ 40 x 8	1-5/8" x 5/16"
9627	■ 50 x 10	2" x 3/8"



	mm 240 x 350 h	9-1/2" x 13-3/4" h
9636	■ 40 x 8	1-5/8" x 5/16"
9637	■ 50 x 10	2" x 3/8"



	mm 200 x 450 h	8" x 17-3/4" h
9646	■ 40 x 8	1-5/8" x 5/16"
9647	■ 50 x 10	2" x 3/8"

■ Ferro pieno quadro
Square iron

■ Ferro pieno piatto
Flat iron

● Ferro pieno tondo
Round iron

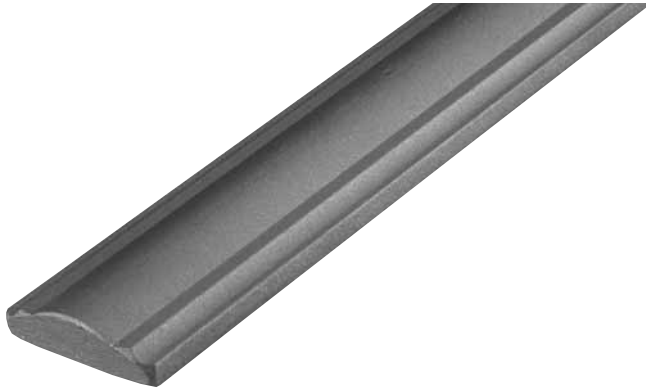

mm 3000 h 118" h

9617	■ 50 x 15	2" x 5/8"
9618	■ 42 x 12	1-11/16" x 1/2"
9618 01	■ 45 x 12	1-3/4" x 1/2"

mm 6000 h 236" h

9617 6M	■ 50 x 15	2" x 5/8"
9618 6M	■ 42 x 12	1-11/16" x 1/2"
9618 01 6M	■ 45 x 12	1-3/4" x 1/2"



mm 150 x 250 h 6" x 10" h

9628	■ 50 x 15	2" x 5/8"
9629	■ 42 x 12	1-11/16" x 1/2"
P1 9618 01	■ 45 x 12	1-3/4" x 1/2"



mm 260 x 350 h 10-1/4" x 13-3/4" h

9638	■ 50 x 15	2" x 5/8"
9639	■ 42 x 12	1-11/16" x 1/2"
P2 9618 01	■ 45 x 12	1-3/4" x 1/2"



mm 250 x 450 h 10" x 17-3/4" h

9648	■ 50 x 15	2" x 5/8"
9649	■ 42 x 12	1-11/16" x 1/2"
P3 9618 01	■ 45 x 12	1-3/4" x 1/2"



mm 700 h 27-1/2" h

P4 9617	■ 50 x 15	2" x 5/8"
P4 9618	■ 42 x 12	1-11/16" x 1/2"
P4 9618 01	■ 45 x 12	1-3/4" x 1/2"

 **Martellato**
Hammered

 **Rifinito a caldo**
Hot finished

 **Forigato a mano**
Hand forged

Particolare finitura
Finish detail

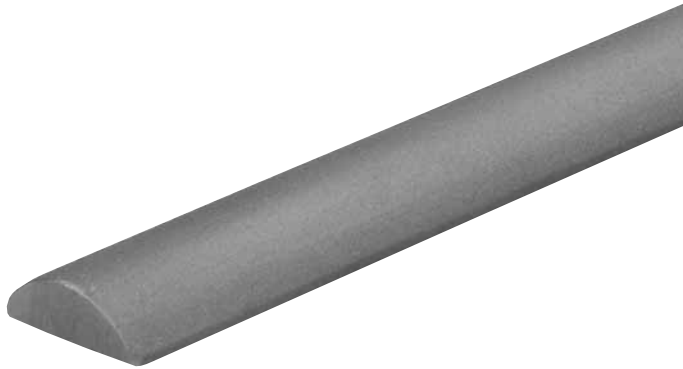

mm 4000 h 236" h

MZTD	■	11 x 3	7/16" x 1/8"
MZTD	■	16 x 5	5/8" x 3/16"
MZTD	■	21 x 6	13/16" x 1/4"



mm 350 h 13-3/4" h

P1 MZTD	■	30 x 8	1-3/16" x 5/16"	P1 MZTD	■	40 x 10	1-5/8" x 3/8"
P1 MZTD	■	30 x 15	1-3/16" x 5/8"	P1 MZTD	■	40 x 12	1-5/8" x 1/2"
P1 MZTD	■	35 x 8	1-3/8" x 5/16"	P1 MZTD	■	40 x 15	1-5/8" x 5/8"
P1 MZTD	■	35 x 10	1-3/8" x 3/8"	P1 MZTD	■	50 x 10	2" x 3/8"
P1 MZTD	■	35 x 15	1-3/8" x 5/8"	P1 MZTD	■	50 x 12	2" x 1/2"
P1 MZTD	■	40 x 8	1-5/8" x 5/16"				

mm 3000 h 118" h

MZTD	■	25 x 7	1" x 1/4"
MZTD	■	30 x 8	1-3/16" x 5/16"
MZTD	■	30 x 15	1-3/16" x 5/8"
MZTD	■	35 x 8	1-3/8" x 5/16"
MZTD	■	35 x 10	1-3/8" x 3/8"
MZTD	■	35 x 15	1-3/8" x 5/8"
MZTD	■	40 x 8	1-5/8" x 5/16"
MZTD	■	40 x 10	1-5/8" x 3/8"
MZTD	■	40 x 12	1-5/8" x 1/2"
MZTD	■	40 x 15	1-5/8" x 5/8"
MZTD	■	50 x 10	2" x 3/8"
MZTD	■	50 x 12	2" x 1/2"

mm 6000 h 236" h

MZTD	■	25x7	6M 1" x 1/4"
MZTD	■	30x8	6M 1-3/16" x 5/16"
MZTD	■	30x15	6M 1-3/16" x 5/8"
MZTD	■	35x8	6M 1-3/8" x 5/16"
MZTD	■	35x10	6M 1-3/8" x 3/8"
MZTD	■	35x15	6M 1-3/8" x 5/8"
MZTD	■	40x8	6M 1-5/8" x 5/16"
MZTD	■	40x10	6M 1-5/8" x 3/8"
MZTD	■	40x12	6M 1-5/8" x 1/2"
MZTD	■	40x15	6M 1-5/8" x 5/8"
MZTD	■	50x10	6M 2" x 3/8"
MZTD	■	50x12	6M 2" x 1/2"



mm 450 h 17-3/4" h

P2 MZTD	■	30 x 8	1-3/16" x 5/16"	P2 MZTD	■	40 x 10	1-5/8" x 3/8"
P2 MZTD	■	30 x 15	1-3/16" x 5/8"	P2 MZTD	■	40 x 12	1-5/8" x 1/2"
P2 MZTD	■	35 x 8	1-3/8" x 5/16"	P2 MZTD	■	40 x 15	1-5/8" x 5/8"
P2 MZTD	■	35 x 10	1-3/8" x 3/8"	P2 MZTD	■	50 x 10	2" x 3/8"
P2 MZTD	■	35 x 15	1-3/8" x 5/8"	P2 MZTD	■	50 x 12	2" x 1/2"
P2 MZTD	■	40 x 8	1-5/8" x 5/16"				

mm 450 h 17-3/4" h

P3 MZTD	■	30 x 8	1-3/16" x 5/16"	P3 MZTD	■	40 x 10	1-5/8" x 3/8"
P3 MZTD	■	30 x 15	1-3/16" x 5/8"	P3 MZTD	■	40 x 12	1-5/8" x 1/2"
P3 MZTD	■	35 x 8	1-3/8" x 5/16"	P3 MZTD	■	40 x 15	1-5/8" x 5/8"
P3 MZTD	■	35 x 10	1-3/8" x 3/8"	P3 MZTD	■	50 x 10	2" x 3/8"
P3 MZTD	■	35 x 15	1-3/8" x 5/8"	P3 MZTD	■	50 x 12	2" x 1/2"
P3 MZTD	■	40 x 8	1-5/8" x 5/16"				

■ *Ferro pieno quadro*
Square iron

■ *Ferro pieno piatto*
Flat iron

● *Ferro pieno tondo*
Round iron

9.6

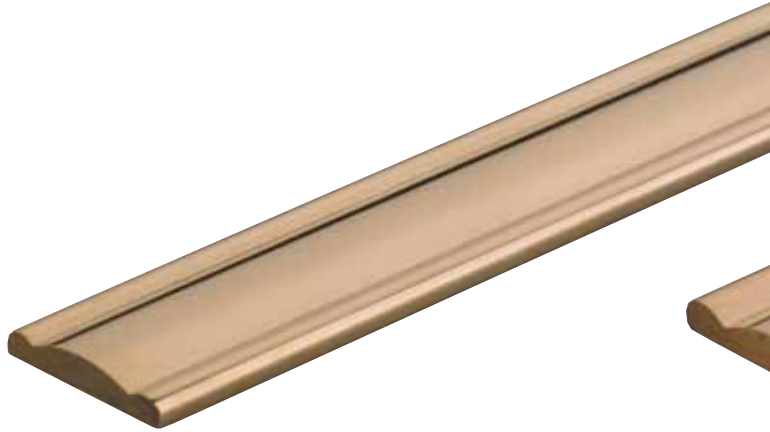

mm 4000 h 157-1/2" h
9619-087 ■ 40 x 8 1-5/8" x 5/16"



mm 4000 h 157-1/2" h
9619-091 ■ 50 x 10 2" x 3/8"

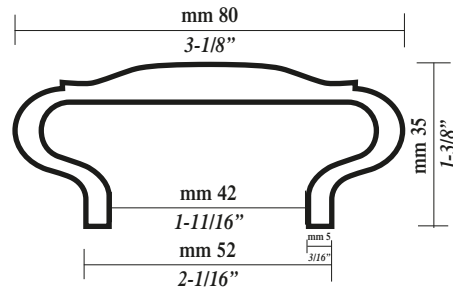
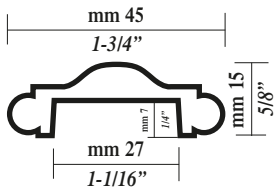

mm 4000 h 157-1/2" h
9619-089 ■ 45 x 15 1-3/4" x 5/8"

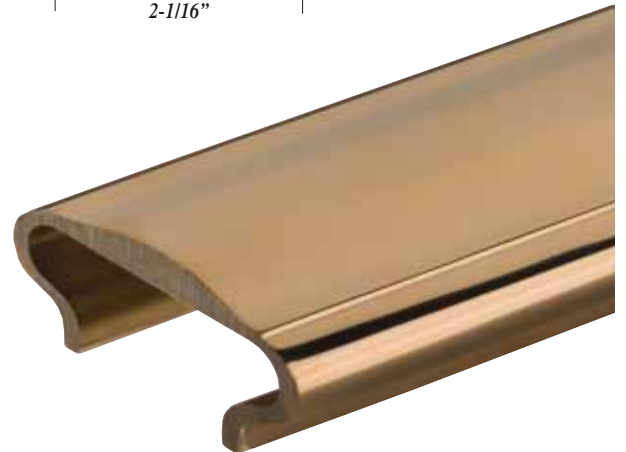

mm 4000 h 157-1/2" h
9619-100 ■ 80 x 35 3-1/8" x 1-3/8"

 Martellato
Hammered

 Rifinito a caldo
Hot finished

 Forigato a mano
Hand forged

Particolare finitura
Finish detail



PIATTO BATTUTO SU 4 SPIGOLI
HAMMERED ALL 4 EDGES FLAT BAR



9.6

mm 3000 h 118" h			mm 6000 h 236" h		
9536	■ 14 x 5	9/16" x 3/16"	9536 6M	■ 14 x 5	9/16" x 3/16"
9537	■ 16 x 8	5/8" x 5/16"	9537 6M	■ 16 x 8	5/8" x 5/16"
9540-075	■ 20 x 10	3/4" x 3/8"	9540-075 6M	■ 20 x 10	3/4" x 3/8"
9538	■ 25 x 8	1" x 5/16"	9538 6M	■ 25 x 8	1" x 5/16"
9540	■ 30 x 8	1-3/16" x 5/16"	9540 6M	■ 30 x 8	1-3/16" x 5/16"
9541	■ 30 x 10	1-3/16" x 3/8"	9541 6M	■ 30 x 10	1-3/16" x 3/8"
9542	■ 40 x 8	1-5/8" x 5/16"	9542 6M	■ 40 x 8	1-5/8" x 5/16"
9543	■ 40 x 10	1-5/8" x 3/8"	9543 6M	■ 40 x 10	1-5/8" x 3/8"
9540-091	■ 50 x 10	2" x 3/8"	9540-091 6M	■ 50 x 10	2" x 3/8"
9540-094	■ 60 x 6	2-3/8" x 1/4"	9540-094 6M	■ 60 x 6	2-3/8" x 1/4"

mm 140 x 250 h - 5-1/2x 10" h		
P1 9540	■ 30 x 8	1-3/16" x 5/16"
P1 9542	■ 40 x 8	1-5/8" x 5/16"



mm 240 x 350 h 9-1/2" x 13-3/4" h		
P2 9540	■ 30 x 8	1-3/16" x 5/16"
P2 9542	■ 40 x 8	1-5/8" x 5/16"

mm 200 x 450 h 8" x 17-3/4" h		
P3 9540	■ 30 x 8	1-3/16" x 5/16"
P3 9542	■ 40 x 8	1-5/8" x 5/16"

■ Ferro pieno quadro
Square iron

■ Ferro pieno piatto
Flat iron

● Ferro pieno tondo
Round iron



QUADRO BATTUTO SU SPIGOLI
HAMMERED EDGES SQUARE BAR

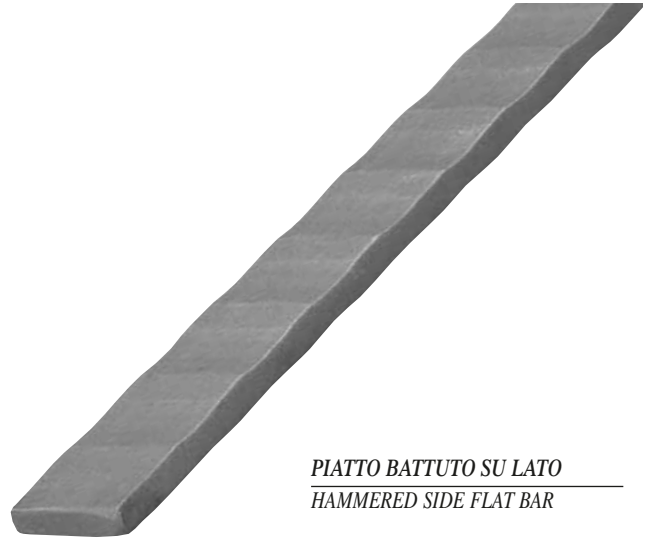

PIATTO BATTUTO SU LATO
HAMMERED SIDE FLAT BAR

9.6

mm 3000 h 118" h		mm 6000 h 236" h	
9544	■ 12 1/2"	9544 6M	■ 12 1/2"
9545	■ 14 9/16"	9545 6M	■ 14 9/16"
9546	■ 16 5/8"	9546 6M	■ 16 5/8"
9547	■ 18 11/16"	9547 6M	■ 18 11/16"
9548	■ 20 3/4"	9548 6M	■ 20 3/4"
9549	■ 25 1"	9549 6M	■ 25 1"
9550	■ 30 1-3/16"	9550 6M	■ 30 1-3/16"
9545-034	■ 40 1-5/8"		

mm 3000 h 118" h	
9552-075	■ 20 x 10 3/4" x 3/8"
9552-079	■ 25 x 8 1" x 5/16"
9551	■ 30 x 8 1-3/16" x 5/16"
9552	■ 30 x 10 1-3/16" x 3/8"
9553	■ 40 x 8 1-5/8" x 5/16"
9552-088	■ 40 x 10 1-5/8" x 3/8"
9552-091	■ 50 x 10 2" x 3/8"
9554	■ 60 x 6 2-3/8" x 1/4"

mm 6000 h 236" h	
9552-075 6M	■ 20 x 10 3/4" x 3/8"
9552-079 6M	■ 25 x 8 1" x 5/16"
9551 6M	■ 30 x 8 1-3/16" x 5/16"
9552 6M	■ 30 x 10 1-3/16" x 3/8"
9553 6M	■ 40 x 8 1-5/8" x 5/16"
9552-088 6M	■ 40 x 10 1-5/8" x 3/8"
9552-091 6M	■ 50 x 10 2" x 3/8"
9554 6M	■ 60 x 6 2-3/8" x 1/4"



QUADRO BATTUTO SU LATO
HAMMERED SIDE SQUARE BAR

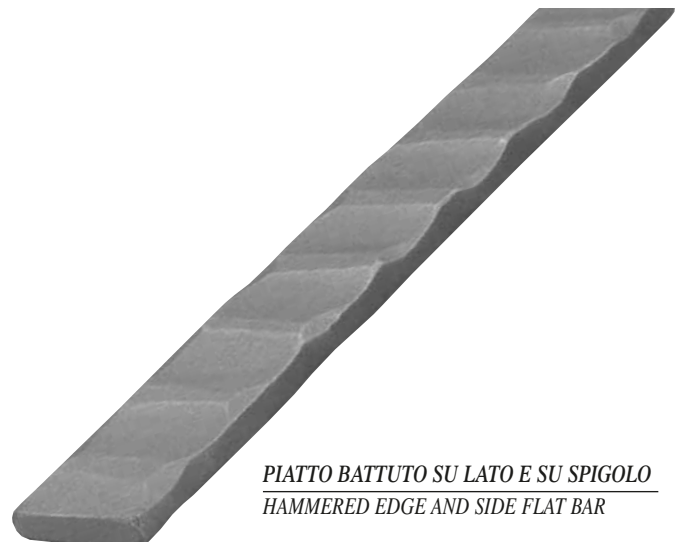

PIATTO BATTUTO SU LATO E SU SPIGOLO
HAMMERED EDGE AND SIDE FLAT BAR

mm 3000 h 118" h		mm 6000 h 236" h	
9555-025	■ 12 1/2"	9555-025 6M	■ 12 1/2"
9555	■ 14 9/16"	9555 6M	■ 14 9/16"
9556	■ 16 5/8"	9556 6M	■ 16 5/8"
9557	■ 18 11/16"	9557 6M	■ 18 11/16"
9558	■ 20 3/4"	9558 6M	■ 20 3/4"
9559	■ 25 1"	9559 6M	■ 25 1"
9560	■ 30 1-3/16"	9560 6M	■ 30 1-3/16"
9555-034	■ 40 1-5/8"	9555-034 6M	■ 40 1-5/8"

mm 3000 h 118" h	
9561-075	■ 20 x 10 3/4" x 3/8"
9561-079	■ 25 x 8 1" x 5/16"
9561-082	■ 30 x 8 1-3/16" x 5/16"
9561-083	■ 30 x 10 1-3/16" x 3/8"
9561-087	■ 40 x 8 1-5/8" x 5/16"
9561-088	■ 40 x 10 1-5/8" x 3/8"
9561-091	■ 50 x 10 2" x 3/8"
9561-094	■ 60 x 6 2-3/8" x 1/4"

mm 6000 h 236" h	
9561-075 6M	■ 20 x 10 3/4" x 3/8"
9561-079 6M	■ 25 x 8 1" x 5/16"
9561-082 6M	■ 30 x 8 1-3/16" x 5/16"
9561-083 6M	■ 30 x 10 1-3/16" x 3/8"
9561-087 6M	■ 40 x 8 1-5/8" x 5/16"
9561-088 6M	■ 40 x 10 1-5/8" x 3/8"
9561-091 6M	■ 50 x 10 2" x 3/8"
9561-094 6M	■ 60 x 6 2-3/8" x 1/4"

 **Martellato**
Hammered

 **Rifinito a caldo**
Hot finished

 **Forigato a mano**
Hand forged

Particolare finitura
Finish detail

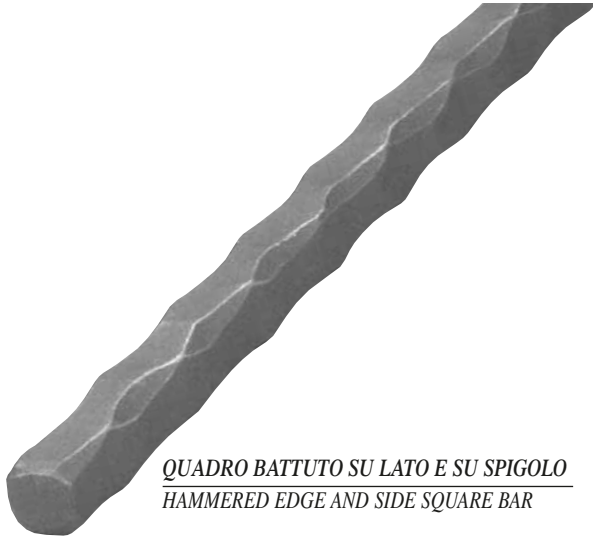

QUADRO BATTUTO SU LATO E SU SPIGOLO
HAMMERED EDGE AND SIDE SQUARE BAR

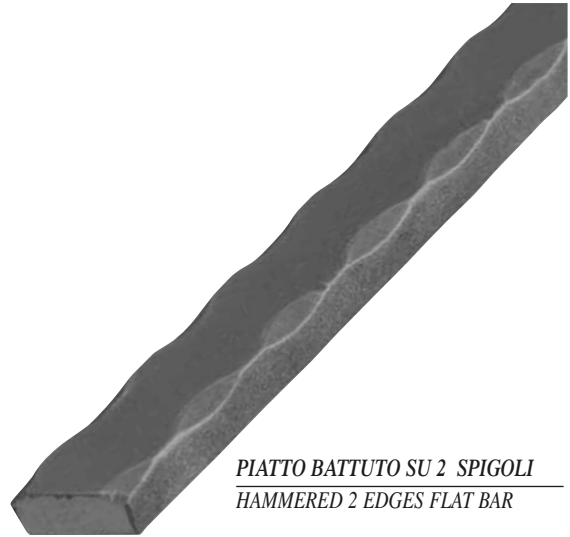

PIATTO BATTUTO SU 2 SPIGOLI
HAMMERED 2 EDGES FLAT BAR

mm 3000 h 118" h			mm 6000 h 236" h		
9562-025	■ 12	1/2"	9562-025 6M	■ 12	1/2"
9562-026	■ 14	9/16"	9562-026 6M	■ 14	9/16"
9562-027	■ 16	5/8"	9562-027 6M	■ 16	5/8"
9562-028	■ 18	11/16"	9562-028 6M	■ 18	11/16"
9562-029	■ 20	3/4"	9562-029 6M	■ 20	3/4"
9562-031	■ 25	1"	9562-031 6M	■ 25	1"
9562-032	■ 30	1-3/16"	9562-032 6M	■ 30	1-3/16"
9562-034	■ 40	1-5/8"			

mm 3000 h 118" h			mm 6000 h 236" h		
9563-075	■ 20 x 10	3/4" x 3/8"	9563-075 6M	■ 20 x 10	3/4" x 3/8"
9563-079	■ 25 x 8	1" x 5/16"	9563-079 6M	■ 25 x 8	1" x 5/16"
9563-082	■ 30 x 8	1-3/16" x 5/16"	9563-082 6M	■ 30 x 8	1-3/16" x 5/16"
9563-083	■ 30 x 10	1-3/16" x 3/8"	9563-083 6M	■ 30 x 10	1-3/16" x 3/8"
9563-087	■ 40 x 8	1-5/8" x 5/16"	9563-087 6M	■ 40 x 8	1-5/8" x 5/16"
9563-088	■ 40 x 10	1-5/8" x 3/8"	9563-088 6M	■ 40 x 10	1-5/8" x 3/8"

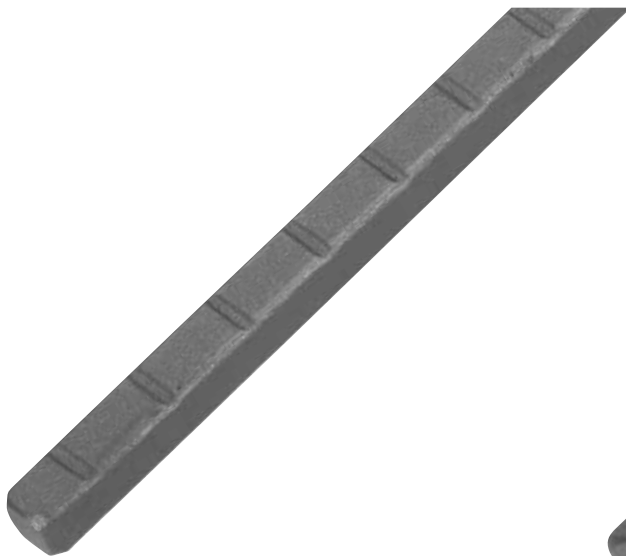

mm 3000 h 118" h		
9566-023	■ 8	5/16" x
9566-024	■ 10	3/8"

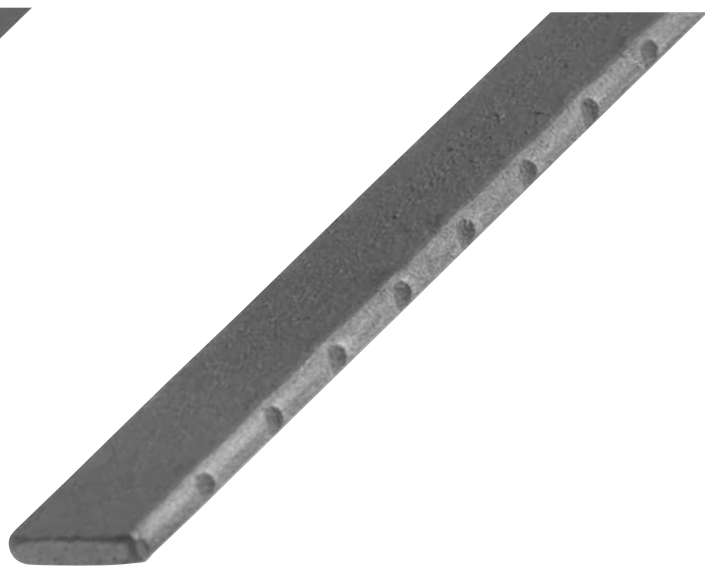

mm 3000 h 118" h		
9566-060	■ 10 x 5	3/8" x 3/16"
9566-063	■ 12 x 6	1/2" x 1/4"
9566-065	■ 14 x 6	3/16" x 1/4"
9566-067	■ 16 x 4	5/8" x 1/8"
9566-069	■ 16 x 6	5/8" x 1/4"
9566-071	■ 20 x 4	3/4" x 1/8"
9566-073	■ 20 x 6	3/4" x 1/4"

■ Ferro pieno quadro
Square iron

■ Ferro pieno piatto
Flat iron

● Ferro pieno tondo
Round iron

9.6



mm 3000 h		118" h		mm 6000 h		235" h	
6065	■ 12	1/2"	6065 6M	■ 12	1/2"		
6066	■ 14	9/16"	6066 6M	■ 14	9/16"		
6067	■ 16	5/8"	6067 6M	■ 16	5/8"		
6068	■ 18	11/16"	6068 6M	■ 18	11/16"		
6069	■ 20	3/4"	6069 6M	■ 20	3/4"		

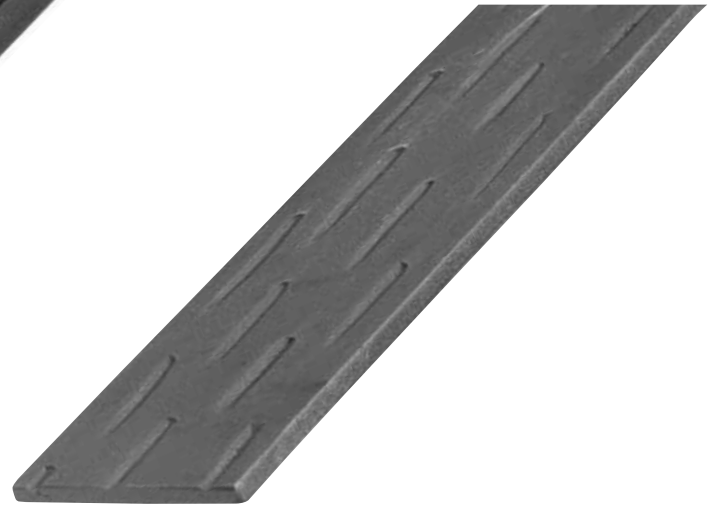

mm 3000 h		118" h	
9565-176	■ 25 x 4	1"-1/4"	
9565-178	■ 25 x 6	1"-1/8"	
9565-180	■ 30 x 4	1"-3/16" x 1/8"	
9565-181	■ 30 x 6	1"-3/16" x 1/4"	
9565-186	■ 40 x 4	1"-5/8" x 1/8"	

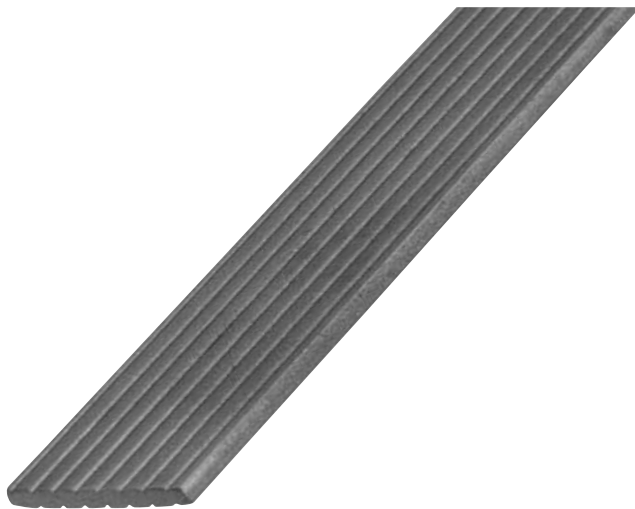

mm 3000 h		118" h	
9565-276	■ 25 x 4	1"-1/4"	
9565-278	■ 25 x 6	1"-1/8"	
9565-280	■ 30 x 4	1"-3/16" x 1/8"	
9565-281	■ 30 x 6	1"-3/16" x 1/4"	
9565-286	■ 40 x 4	1"-5/8" x 1/8"	

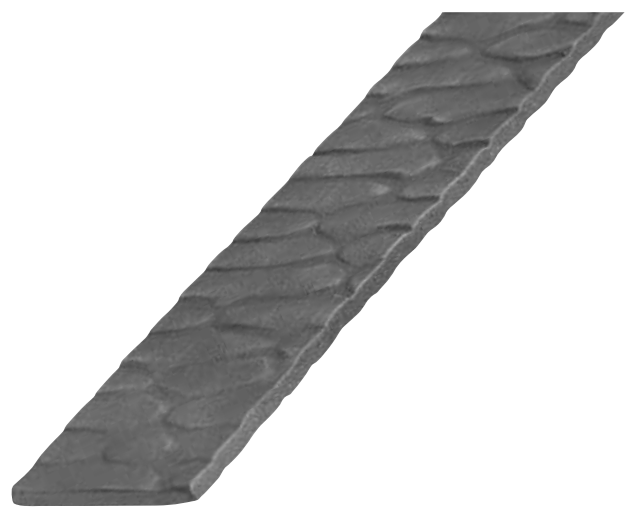

mm 3000 h		118" h	
9565-376	■ 25 x 4	1" x 1/8"	
9565-378	■ 25 x 6	1" x 1/4"	
9565-380	■ 30 x 4	1-3/16" x 1/8"	
9565-381	■ 30 x 6	1-3/16" x 1/4"	
9565-386	■ 40 x 4	1-5/8" x 1/8"	



Martellato
Hammered

Rifinito a caldo
Hot finished

Forigato a mano
Hand forged

Particolare finitura
Finish detail

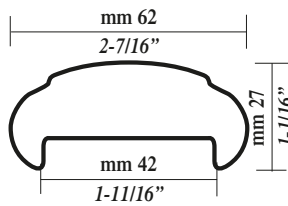
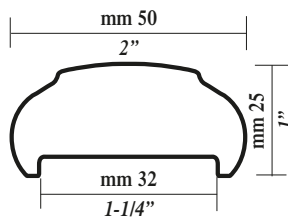
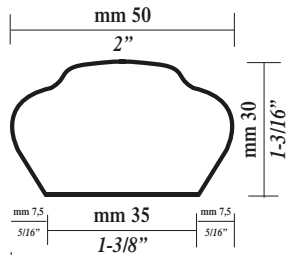

	mm 3000 h	118" h			
9800	□ 20	3/4"	sp 2	th 1/16"	
9801	□ 25	1"	sp 2	th 1/16"	
9802	□ 30	1-3/16"	sp 2,5	th 1/8"	
9803	□ 40	1-5/8"	sp 2,5	th 1/8"	
9804	□ 50	2"	sp 3	th 1/8"	
9805	□ 60	2-3/8"	sp 3	th 1/8"	
9806	□ 80	3-1/8"	sp 3	th 1/8"	

	mm 3000 h	118" h			
9810	□ 30 x 20	1-3/16" x 3/4"	sp 2	th 1/16"	
9811	□ 40 x 20	1-5/8" x 3/4"	sp 2	th 1/16"	
9812	□ 50 x 30	2" x 1-3/16"	sp 2,5	th 1/8"	
9813	□ 50 x 40	2" x 1-5/8"	sp 3	th 1/8"	
9814	□ 60 x 40	2-3/8" x 1-5/8"	sp 3	th 1/8"	
9814 002	□ 100x40	4" x 1-5/8"	sp 3	th 1/8"	

	mm 6000 h	236" h			
9800 6M	□ 20	3/4"	sp 2	th 1/16"	
9801 6M	□ 25	1"	sp 2	th 1/16"	
9802 6M	□ 30	1-3/16"	sp 2,5	th 1/8"	
9803 6M	□ 40	1-5/8"	sp 2,5	th 1/8"	
9804 6M	□ 50	2"	sp 3	th 1/8"	
9805 6M	□ 60	2-3/8"	sp 3	th 1/8"	
9806 6M	□ 80	3-1/8"	sp 3	th 1/8"	

	mm 6000 h	236" h			
9810 6M	□ 30 x 20	1-3/16" x 3/4"	sp 2	th 1/16"	
9811 6M	□ 40 x 20	1-5/8" x 3/4"	sp 2	th 1/16"	
9812 6M	□ 50 x 30	2" x 1-3/16"	sp 2,5	th 1/8"	
9813 6M	□ 50 x 40	2" x 1-5/8"	sp 3	th 1/8"	
9814 6M	□ 60 x 40	2-3/8" x 1-5/8"	sp 3	th 1/8"	
9814 002 6M	□ 100x40	4" x 1-5/8"	sp 3	th 1/8"	



	mm 6000 h	236" h		
9819-MT5	50 x 30	2" x 1-3/16"		

	mm 6000 h	236" h		
9819-MT8	62 x 27	2-7/16" x 1-1/16"		

	mm 6000 h	236" h		
9819-MT9	50 x 25	2" x 1"		

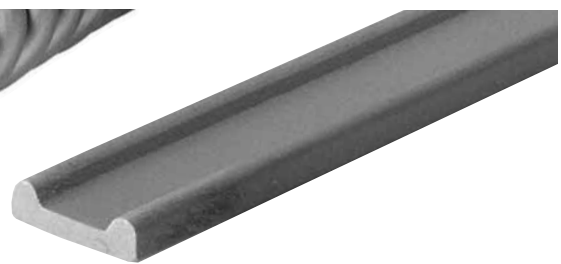
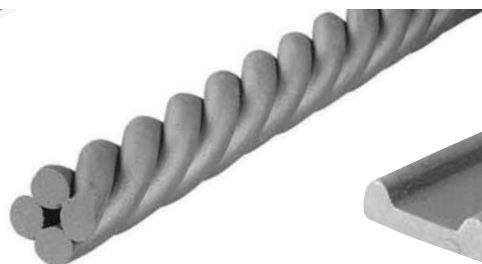

	mm 2700 h	107" h		
9820	Ø 16	5/8"		
9822	Ø 20	3/4"		

	mm 2700 h	107" h		
9824	Ø 30	1-3/16"		
9825	Ø 35	1-3/8"		

	mm 3000 h	118" h		
10005-082	■ 30 x 8	1-3/16" x 5/16"		

■ **Ferro pieno quadro**
Square iron

■ **Ferro pieno piatto**
Flat iron

● **Ferro pieno tondo**
Round iron

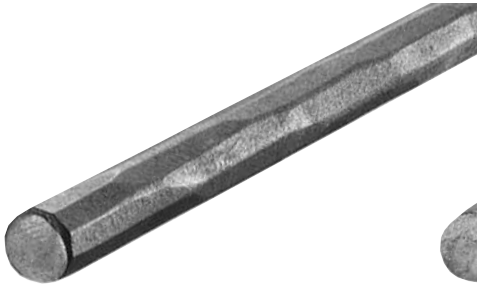

	mm 2000 h	78-3/4" h
9840	● 12	1/2"
9841	● 14	9/16"
9842	● 16	5/8"
9843	● 18	11/16"
9844	● 20	3/4"
9845	● 22	7/8"
9846	● 25	1"
9847	● 30	1-3/16"

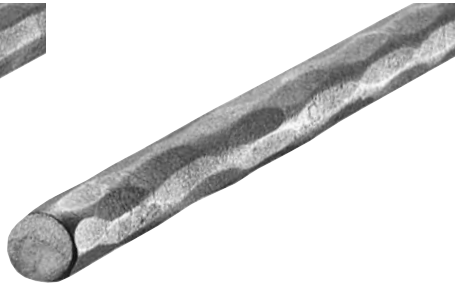

	mm 2000 h	78-3/4" h
9850	● 12	1/2"
9851	● 14	9/16"
9852	● 16	5/8"
9853	● 18	11/16"
9854	● 20	3/4"
9855	● 22	7/8"
9856	● 25	1"
9857	● 30	1-3/16"

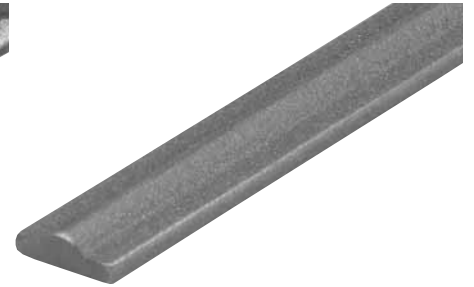

	mm 14 x 4 h	9/16" x 1/8" h
10001	2000 h	78-3/4" h
10002	4000 h	157-1/2" h
	mm 18 x 5 h	11/16" x 3/16" h
10003	2000 h	78-3/4" h
10004	4000 h	157-1/2" h

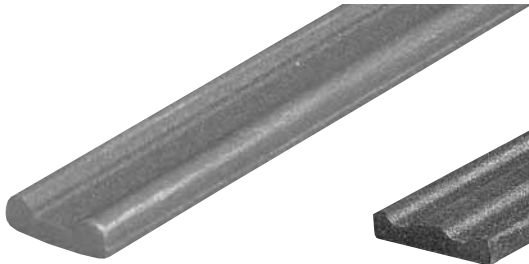

	mm 14 x 4 h	9/16" x 1/8" h
10005	2000 h	78-3/4" h
10006	4000 h	157-1/2" h
	mm 18 x 5 h	11/16" x 3/16" h
10007	2000 h	78-3/4" h
10008	4000 h	157-1/2" h

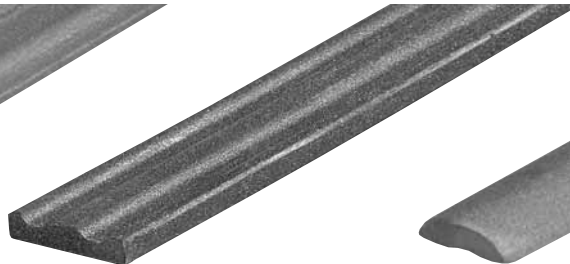

	mm 14 x 4 h	9/16" x 1/8" h
10009-064	3000 h	78-3/4" h
10009-064 4M	4000 h	157-1/2" h
	mm 20 x 4 h	3/4" x 1/8" h
10009-071	2000 h	78-3/4" h
10009-071 4M	4000 h	157-1/2" h

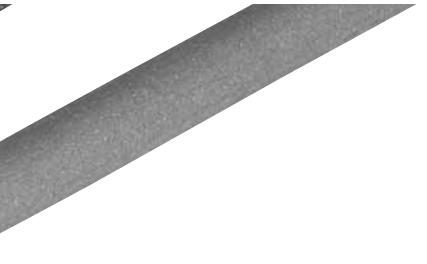

	mm 14 x 4 h	9/16" x 1/8" h
10010	2000 h	78-3/4" h
10011	4000 h	157-1/2" h



	■ 14 x 4	9/16" x 1/8"
10015	2 pz - 8 x 8	2 pcs - 5/16" x 5/16"
10016	3 pz - 8 x 8	3 pcs - 5/16" x 5/16"
10017	2 pz - 10 x 5	2 pcs - 3/8" x 3/16"
10018	3 pz - 10 x 5	3 pcs - 3/8" x 3/16"
10019	2 pz - 10 x 10	2 pcs - 3/8" x 3/8"
10020	2 pz - 12 x 6	2 pcs - 1/2" x 1/4"
10021	3 pz - 12 x 6	3 pcs - 1/2" x 1/4"
10022	4 pz - 12 x 6	4 pcs - 1/2" x 1/4"



	■ 14 x 4	9/16" x 1/8"
10025	2 pz - 12 x 6	2 pcs - 1/2" x 1/4"
10026	4 pz - 12 x 6	4 pcs - 1/2" x 1/4"
10027	6 pz - 12 x 6	6 pcs - 1/2" x 1/4"
10028	3 pz - 8 x 8	3 pcs - 5/16" x 5/16"



	■ 14 x 4	9/16" x 1/8"
10030	2 pz - 20 x 6	2 pcs - 3/4" x 1/4"
10031	2 pz - 12 x 6	2 pcs - 1/2" x 1/4"
10032	4 pz - 12 x 6	4 pcs - 1/2" x 1/4"

 *Martellato*
Hammered

 *Rifinito a caldo*
Hot finished

 *Forigato a mano*
Hand forged

Particolare finitura
Finish detail



mm Ø 70
Ø 2-3/4"

9680 



mm Ø 80 x 120 h
Ø 3-1/8" x 4-3/4" h

9683  ■ 26 1-1/16"



mm Ø 70
Ø 2-3/4"

9685 



mm Ø 55
Ø 2-3/16"

9687  90 h 3-1/2" h



mm Ø 80
Ø 3-1/8"

9688  130 h 5-1/8" h



mm Ø 30
Ø 1-3/16"

9692 01  45 h 1-3/4" h



mm Ø 45
Ø 1-3/4"

9692 02  55 h 2-3/16" h



mm Ø 55
Ø 2-3/16"

9692 03  75 h 3" h



mm Ø 65
Ø 2-9/16"

9692 04  85 h 3-3/8" h



mm Ø 50 x 95 h
Ø 2" x 3-3/4"

9695 



mm Ø 55
Ø 2-3/16"

9696  130 h 5-1/8" h



mm Ø 60
Ø 2-3/8"

9697  130 h 5-1/8" h



mm 55 x 95 h
2-3/16" x 3-3/4" h

9698  20 3/4"



mm 55 x 95 h
2-3/16" x 3-3/4" h

9699  20 3/4"
 32 1-1/4"

■ Ferro pieno quadro
Square iron

■ Ferro pieno piatto
Flat iron

● Ferro pieno tondo
Round iron



mm 50 x 50 h
2'' x 2'' h

9665-112Q	sp 6	th 1/4''
	□ 12,5	1/2''
9665-116Q	sp 6	th 1/4''
	□ 16,5	11/16''



mm 70 x 70 h
2-3/4'' x 2-3/4'' h

9665-216Q	sp 8	th 5/16''
	□ 16,5	11/16''
9665-221Q	sp 8	th 5/16''
	□ 21	13/16''

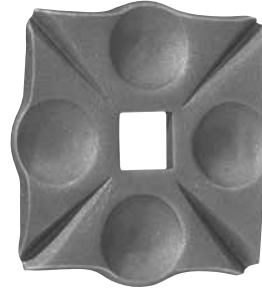

mm 90 x 90 h
3-1/2'' x 3-1/2'' h

9665-321Q	sp 8	th 5/16''
	□ 21	13/16''
9665-326Q	sp 8	th 5/16''
	□ 26	1-1/16''



mm 110 x 110 h
4-3/8'' x 4-3/8'' h

9665-426Q	sp 10	th 3/8''
	□ 26	1-1/16''
9665-431Q	sp 10	th 3/8''
	□ 31	1-1/4''



mm 60 x 60 h
2-3/8'' x 2-3/8'' h

9667-100	sp 4	th 1/8''
-----------------	------	----------



mm 60 x 60 h
2-3/8'' x 2-3/8'' h

9667-113Q	sp 4	th 1/8''
	□ 13	1/2''



mm 60 x 60 h
2-3/8'' x 2-3/8'' h

9667-117Q	sp 4	th 1/8''
	□ 17	11/16''



mm 80 x 80 h
3-1/8'' x 3-1/8'' h

9667-200	sp 4	th 1/8''
-----------------	------	----------



mm 80 x 80 h
3-1/8'' x 3-1/8'' h

9667-221Q	sp 4	th 1/8''
	□ 21	13/16''



mm 80 x 80 h
3-1/8'' x 3-1/8'' h

9667-226Q	sp 4	th 1/8''
	□ 26	1-1/16''

 *Martellato*
Hammered

 *Foro quadro*
Square hole

 *Foro tondo*
Round hole

Particolare finitura
Finish detail

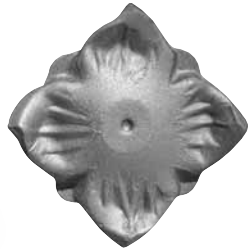

mm 65 x 65 h
2-9/16" x 2-9/16" h

9668 01 sp 5 th 3/16"

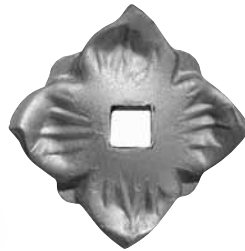

mm 65 x 65 h
2-9/16" x 2-9/16" h

9668 02 sp 5 th 3/16"
□ 13 1/2"



mm 65 x 65 h
2-9/16" x 2-9/16" h

9668 03 sp 5 th 3/16"
□ 17 11/16"

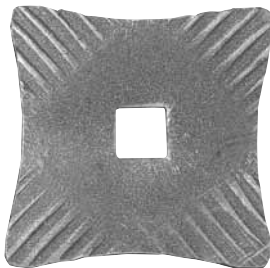

mm 75 x 75 h
3" x 3" h

9670 sp 5 th 3/16"
□ 14 9/16"

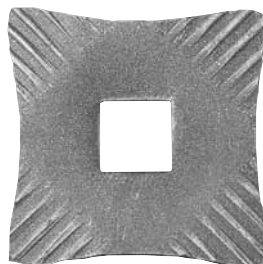

mm 75 x 75 h
3" x 3" h

9671 sp 5 th 3/16"
□ 20 3/4"

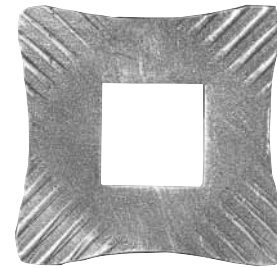

mm 75 x 75 h
3" x 3" h

9671 02 sp 5 th 3/16"
□ 30 1-3/16"



mm 65 x 65 h
2-9/16" x 2-9/16" h

9672 sp 3 th 11/8"



mm 65 x 65 h
2-9/16" x 2-9/16" h

9672-013Q sp 3 th 11/8"
□ 13 1/2"



mm 65 x 65 h
2-9/16" x 2-9/16" h

9672-017Q sp 3 th 11/8"
□ 17 11/16"

■ *Ferro pieno quadro*
Square solid iron

■ *Ferro pieno piatto*
Flat solid iron

● *Ferro pieno tondo*
Round iron



mm 75 x 75 h
3"x 3" h

9673 sp 3 th 1/8"



mm 75 x 75 h
3"x 3" h

9673-013Q sp 3 th 1/8"
□ 13 1/2"



mm 75 x 75 h
3"x 3" h

9673-017Q sp 3 th 1/8"
□ 17 11/16"

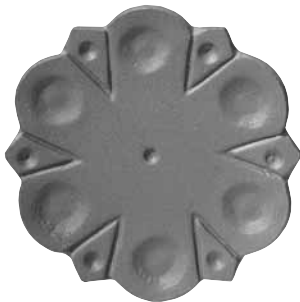

mm 110 x 110 h
4-3/8"x 4-3/8" h

9674 sp 4 th 1/8"



mm 110 x 110 h
4-3/8"x 4-3/8" h

9674-021Q sp 4 th 1/8"
□ 21 13/16"



mm 110 x 110 h
4-3/8"x 4-3/8" h

9674-026Q sp 4 th 1/8"
□ 26 1-1/16"

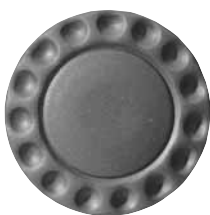

Ø 85
Ø 3-3/8"

9678 sp 3 th 1/8"



Ø 85
Ø 3-3/8"

9678-021T sp 3 th 1/8"
○ 21 1-13/16"



Ø 85
Ø 3-3/8"

9678-026T sp 3 th 1/8"
○ 26 1-1/16"

 *Martellato*
Hammered

 *Foro quadro*
Square hole

 *Foro tondo*
Round hole

Particolare finitura
Finish detail

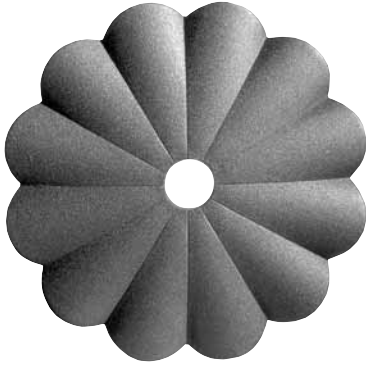

sp 3
th 1/8"

9675 Ø 115 4-1/2" ○ 12 1/2"

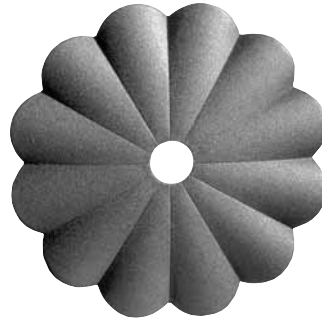

sp 3
th 1/8"

9676 Ø 95 3-3/4" ○ 12 1/2"

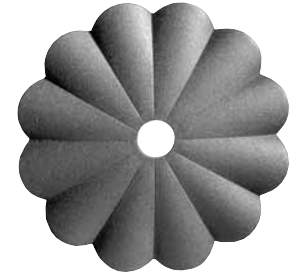

sp 3
th 1/8"

9677 Ø 65 2-9/16" ○ 6 1/4"



Ø mm 90 x 20 h
3-1/2" x 3/4" h

9676-001 sp 3 th 1/8"
○ 12 1/2"



mm 100 x 100 h
4" x 4" h

10438 sp 8 th 5/16"



mm 100 x 100 h
4" x 4" h

10438-025Q sp 8 th 5/16"
□ 25 1"
10438-030Q sp 8 th 5/16"
□ 30 1-3/16"



mm 120 x 120 h
4-3/4" x 4-3/4" h

10416-100 sp 10 th 3/8"



mm 120 x 120 h
4-3/4" x 4-3/4" h

10416-200  sp 10 th 3/8"

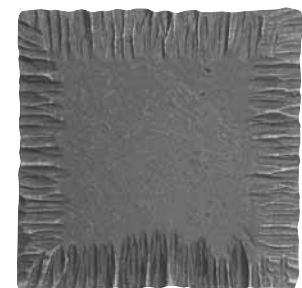

mm 120 x 120 h
4-3/8" x 4-3/8" h

10416-500  sp 10 th 3/8"

■ *Ferro pieno quadro*
Square solid iron

■ *Ferro pieno piatto*
Flat solid iron

⬆ *Martellato*
Hammered



mm 40 x 40 h
1-5/8" x 1-5/8" h

10422
10423 □ 12,5 1/2"
10424 □ 14,5 9/16"



mm 50 x 50 h
2" x 2" h

10426
10427 □ 16,5 11/16"
10428 □ 18,5 3/4"



mm 80 x 80 h
3-1/8" x 3-1/8" h

10435
10436 □ 25,5 1-1/16"
10437 □ 30,5 1-1/4"



mm 85 x 85 x 22 h
3-3/8" x 3-3/8" x 7/8" h

10418 □ 15 5/8"
10420 □ 30,5 1-1/4"

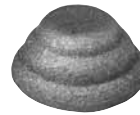

mm Ø 30
1-3/16" h

10440



mm Ø 30
1-3/16" h

10441 ○ 12,5 1/2"



mm Ø 50
2" h

10442



mm Ø 60
2-3/8" h

10446

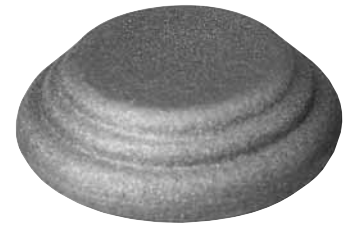

mm Ø 80
3-1/8" h

10448



mm Ø 50
2" h

10443 ○ 16,5 11/16"
10444 ○ 18,5 3/4"



mm Ø 60
2-3/8" h

10447 ○ 25,5 1-1/16"



mm Ø 80
3-1/8" h

10449 ○ 30,5 1-1/4"



 Rifinito a caldo
Hot finished

Foro quadro
Square hole



Foro tondo
Round hole

Particolare finitura
Finish detail





mm 900 x 300 h
35-1/2" x 12" h
4200   20 x 6 3/4" x 1/4"



mm 930 x 250 h
36-5/8" x 10" h
4205   12 x 6 1/2" x 1/4"



mm 840 x 240 h
33" x 9-1/2" h
4207   16 x 8 5/8" x 5/16"

■ Ferro pieno quadro
Square iron

■ Ferro pieno piatto
Flat iron

● Ferro pieno tondo
Round iron



mm 1200 x 200 h
47-1/4" x 8" h
4210 ■ 12 x 6 1/2" x 1/4"



mm 700 x 350 h
27-1/2" x 13-3/4" h
4215 ◀ ■ 16 x 8 5/8" x 5/16"



mm 1600 x 270 h
63" x 10-5/8" h
4220 ■ 12 x 6 1/2" x 1/4"



⚒ *Martellato*
Hammered

🔥 *Rifinito a caldo*
Hot finished

✋ *Forigato a mano*
Hand forged

Particolare finitura
Finish detail



mm 1500 x 350 h
59" x 13-3/4" h
4226-045 ●12 1/2"

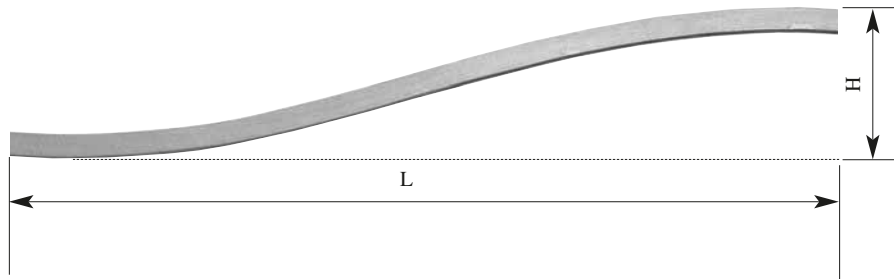

mm 1500 x 350 h 59" x 13-3/4" h		
9905	■	30 x 8 1-3/16" x 5/16"
9906	⚒	30 x 8 1-3/16" x 5/16"
9915	■	35 x 6 1-3/8" x 1/4"
9916	⚒	35 x 6 1-3/8" x 1/4"
9925	■	40 x 8 1-5/8" x 5/16"
9926	⚒	40 x 8 1-5/8" x 5/16"

mm 2000 x 400 h 78-3/4" x 15-3/4" h		
9910	■	30 x 8 1-3/16" x 5/16"
9911	⚒	30 x 8 1-3/16" x 5/16"
9920	■	35 x 6 1-3/8" x 1/4"
9921	⚒	35 x 6 1-3/8" x 1/4"
9930	■	40 x 8 1-5/8" x 5/16"
9931	⚒	40 x 8 1-5/8" x 5/16"

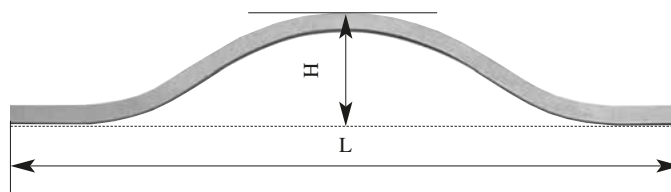

mm 1200 x 200 h 47-1/4" x 8" h		
9950	■	30 x 8 1-3/16" x 5/16"
9951	⚒	30 x 8 1-3/16" x 5/16"

mm 1200 x 200 h 47-1/4" x 8" h		
9955	■	35 x 6 1-3/8" x 1/4"
9956	⚒	35 x 6 1-3/8" x 1/4"

mm 1200 x 200 h 47-1/4" x 8" h		
9960	■	40 x 8 1-5/8" x 5/16"
9961	⚒	40 x 8 1-5/8" x 5/16"

■ Ferro pieno quadro
Square iron

■ Ferro pieno piatto
Flat iron

● Ferro pieno tondo
Round iron



mm 800 x 280 h
31-1/2" x 11" h

4225-164B ◀ 🔥 ■ 14 x 5 9/16" x 3/16"

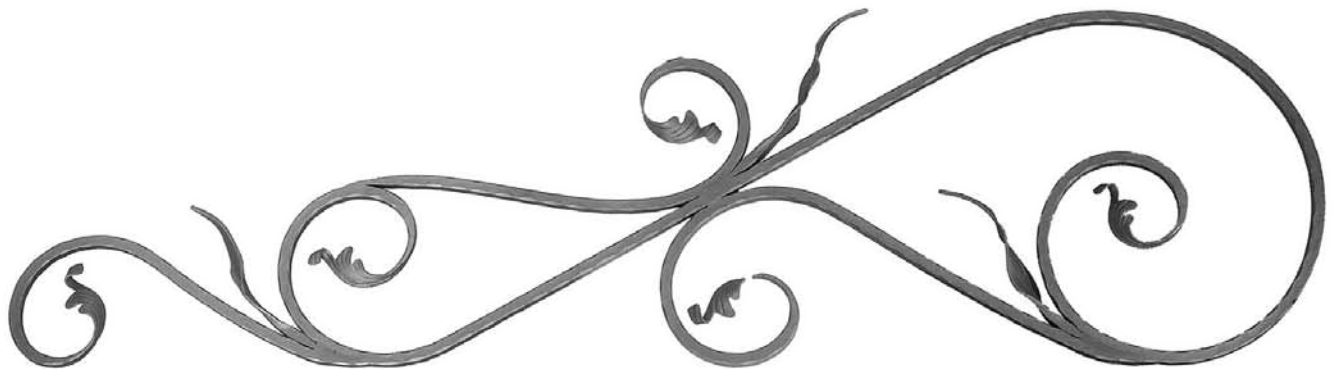

mm 1600 x 450 h
63" x 17-3/4" h

9980 ◀ 🔥 ■ 14 9/16"

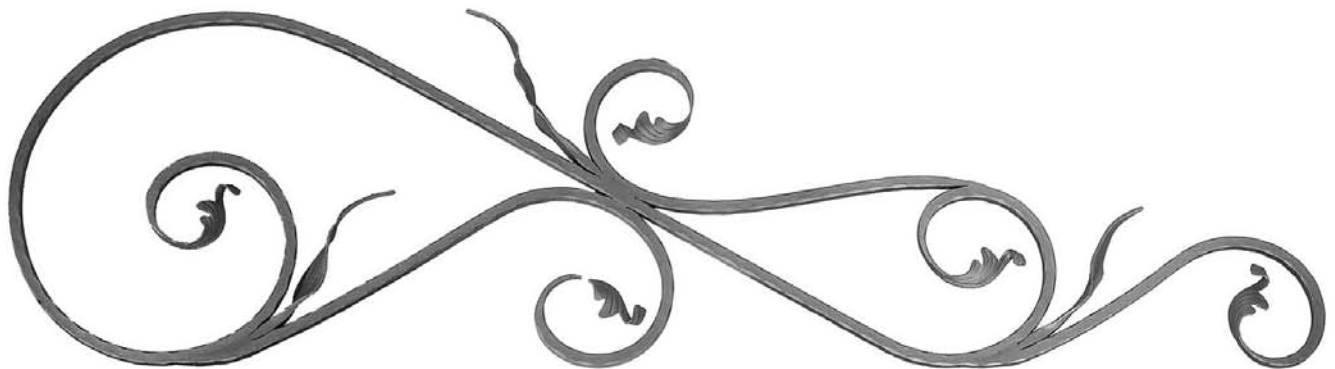

mm 1600 x 450 h
63" x 17-3/4" h

9981 ◀ 🔥 ■ 14 9/16"



 *Martellato*
Hammered

 *Rifinito a caldo*
Hot finished



 *Forigato a mano*
Hand forged

Particolare finitura
Finish detail



mm 850 x 260 h
33-1/2" x 10-1/4" h
9985   ■ 14 9/16"



mm 850 x 260 h
33-1/2" x 10-1/4" h
9986   ■ 14 9/16"

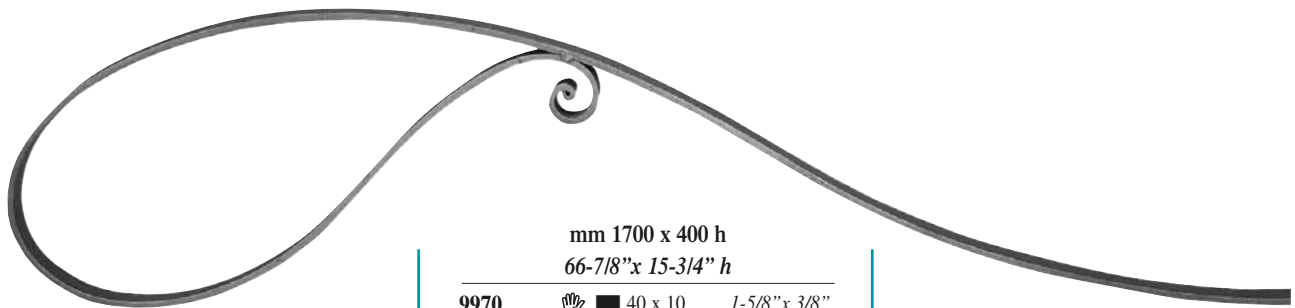

mm 1700 x 400 h
66-7/8" x 15-3/4" h
9970  ■ 40 x 10 1-5/8" x 3/8"



mm 1200 x 240 h
47-1/4" x 9-1/2" h
9975  ■ 40 x 10 1-5/8" x 3/8"

⚒ *Martellato*
Hammered

🔥 *Rifinito a caldo*
Hot finished

✋ *Forigato a mano*
Hand forged

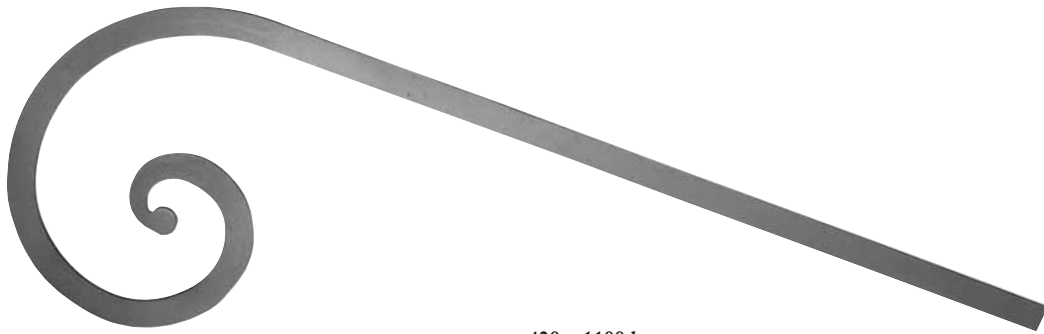

mm 420 x 1100 h
16-1/2" x 43-1/4" h
9990 ✋ ■ 40 x 8 1-5/8" x 5/16"



mm 420 x 1100 h
16-1/2" x 43-1/4" h
9991 ⚒ ✋ ■ 40 x 8 1-5/8" x 5/16"



mm 290 x 1100 h
11-3/8" x 43-1/4" h
9994 ✋ ■ 40 x 8 1-5/8" x 5/16"

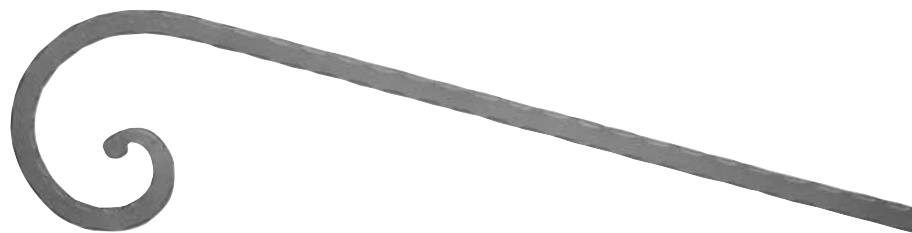

mm 290 x 1100 h
11-3/8" x 43-1/4" h
9995 ⚒ ✋ ■ 40 x 8 1-5/8" x 5/16"