



7 BARRE

- 7.1 BARRE STAMPATE
- 7.2 BARRE FORATE STANDARD
- 7.2 BARRE SABBIATE FORATE STANDARD
- 7.2 BARRE FORATE STANDARD LUCE 110
- 7.2 BARRE SABBIATE FORATE STANDARD LUCE 110
- 7.2 BARRE FORATE SU MISURA
- 7.3 PIANTONI "PORTOFINO"
- 7.5 PANNELLI CON NODO
- 7.7 PALETTI CON NODO
- 7.8 PALETTI PER RECINZIONI
- 7.9 PALETTI PER RECINZIONI

7 BARS

- 7.1 STAMPED BARS
- 7.2 STANDARD HOLED BARS
- 7.2 SAND-BLASTED STANDARD HOLED BARS
- 7.2 STANDARD HOLED BARS OPEN SPACE 110 MM
- 7.2 SAND-BLASTED STANDARD HOLED BARS OPEN SPACE 110 MM
- 7.2 CUSTOM MADE HOLED BARS
- 7.3 "PORTOFINO" BARS
- 7.5 KNOTED PANELS
- 7.7 KNOTED BALUSTERS
- 7.8 FENCING BALUSTERS
- 7.9 FENCING BALUSTERS



Esecuzione barre forate
Holed bars manufacturing



Esecuzione nodi
Knots manufacturing



Molatura piantone "Portofino"
"Portofino" baluster grinding



Esecuzione piantone "Portofino"
"Portofino" baluster manufacturing

CALAMINA

CALAMINE - ZUNDER - CALAMINA - CALAMINE

Quando le barre di ferro vengono riscaldate e rese incandescenti, la superficie esterna a contatto con i gas e le impurità presenti nell'aria, per effetto di combinazione chimica, forma una piccola pellicola di colore scuro chiamata "calamina" che a temperatura ambiente si presenta a forma di scaglie rigide che proteggono il ferro dagli agenti atmosferici.

When the iron bars are heated and become incandescent, the external surface gets in touch with gas and impurities. In consequence of a chemical combination, a thin dark membrane called "calamine" forms on the surface. At ambient temperature this membrane appears in form of stiff scales that protects the iron from the atmospheric agents.

Wenn die Stangen erhitzt und zur Glut gebracht werden, die Oberfläche kommt in Kontakt mit Gasen und Verunreinigungen die sich in der Luft befinden. Aufgrund einer chemischen Kombination, entsteht eine dünne dunkelfarbige Schicht, die „Zunder“ genannt wird. Diese Schicht sieht wie harte Schuppen aus, die das Eisen vor atmosphärischen Eingriffen schützen.

Cuando las barras de hierro son calentadas y se vuelven candentes, la superficie exterior que está en contacto con los gases y las impurezas presentes en el aire, por efecto de una combinación química forma una película sutil y oscura llamada "calamina".

A temperatura ambiente la calamina se presenta en forma de esquilas rígidas que protegen el hierro de los agentes atmosféricos.

Quand les barres en fer sont chauffées et incandescentes la surfaces extérieure en contact avec les gaz et les impuretés de l'air, sous l'effet d'une combinaison chimique, forme une petite pellicule foncée qui s'appelle calamine. A température ambiante la calamine apparaît sous forme d'éclats durs qui protègent le fer contre les agents atmosphériques.



BARRE

BARS

7

Artifer®



particolari che fanno la differenza • details which make the difference

SABBIATURA - SANDBLASTING

SANDBLASSEN - ARENADO - SABLAGE

Questa operazione viene eseguita per pulire i metalli sulla loro superficie, qualora si vuole togliere qualsiasi impurità come la “calamina”. Consiste nel far passare il pezzo attraverso un getto ad alta pressione di sabbia o pallini. Questo getto toglie qualsiasi impurità esterna e predispone il materiale a ricevere trattamenti come zincatura o verniciatura. Bisogna tener presente che il ferro sabbiato è un ferro nudo, spogliato di qualsiasi protezione ed esposto agli agenti atmosferici come ruggine se non viene immediatamente trattato.

This process is made for cleaning the metals on their surface when you want to remove any impurity, like the “calamine”.

Sandblasting consists in passing the piece through a sand or shots high pressure jet.

This jet removes any external impurity and prepare the material for following treatments like galvanization and varnishing.

Keep in mind that the sandblasted iron is a bare iron, deprived of any protection and exposed to atmospheric agents like rust.

That is why it is very important to treat it immediately.

Dieser Vorgang wird ausgeführt um die Oberflächen der Metallen zu säubern und Verunreinigungen wie z.b. „Zunder“ von der Oberfläche zu entfernen. Das Werkstück wird durch einen Hochdruckstrahl aus Sand oder kleineren Kugeln durchgeführt. Dieser Strahl entfernt jegliche äussere Verunreinigung und bereitet das Material für weitere Bearbeitungen wie Verzinkung oder Lackauftrag vor. Es ist ratsam zu bedenken, daß sandgeblasenes Eisen, nacktes Eisen ist d.h. befreit von jeglichem Schutz und ist den äußeren Angriffen ausgesetzt, wie Rostbildung, sollte es nicht unmittelbar behandelt werden.

Esta operación se hace para limpiar la superficie de los metales cuando queramos sacar cualquier impureza como la “calamina”.

Consiste en el pasar la pieza a través de un chorro de arena o bolas de alta presión.

Ese chorro saca cualquier impureza exterior y prepara el material para ser sucesivamente cincado y pintado. Es necesario tener presente que el hierro arenado es un hierro en bruto, espolado de cualquier protección y expuesto a los agentes atmosféricos como el óxido.

Por esto es importante que sea tratado en seguida.

On fait ce procédé pour nettoyer la surface des métaux quand on veut enlever n'importe quelle impureté comme la “calamine”.

La pièce passe à travers un jet a haute pression de sable ou plombs qui enlève toutes les impuretés extérieures et prépare le matériau aux traitement de zingage ou de vernissage.

Il faut tenir compte que le fer sablé est un fer nu, sans protection et exposé aux agents atmosphériques comme la rouille.

Pour cette raison il est nécessaire de le traiter immédiatement.

 *Martellato*
Hammered

 *Rifinito a caldo*
Hot finished

 *Interasse*
Pitch

 *Foro tondo*
Round hole

Particolare finitura
Finish detail

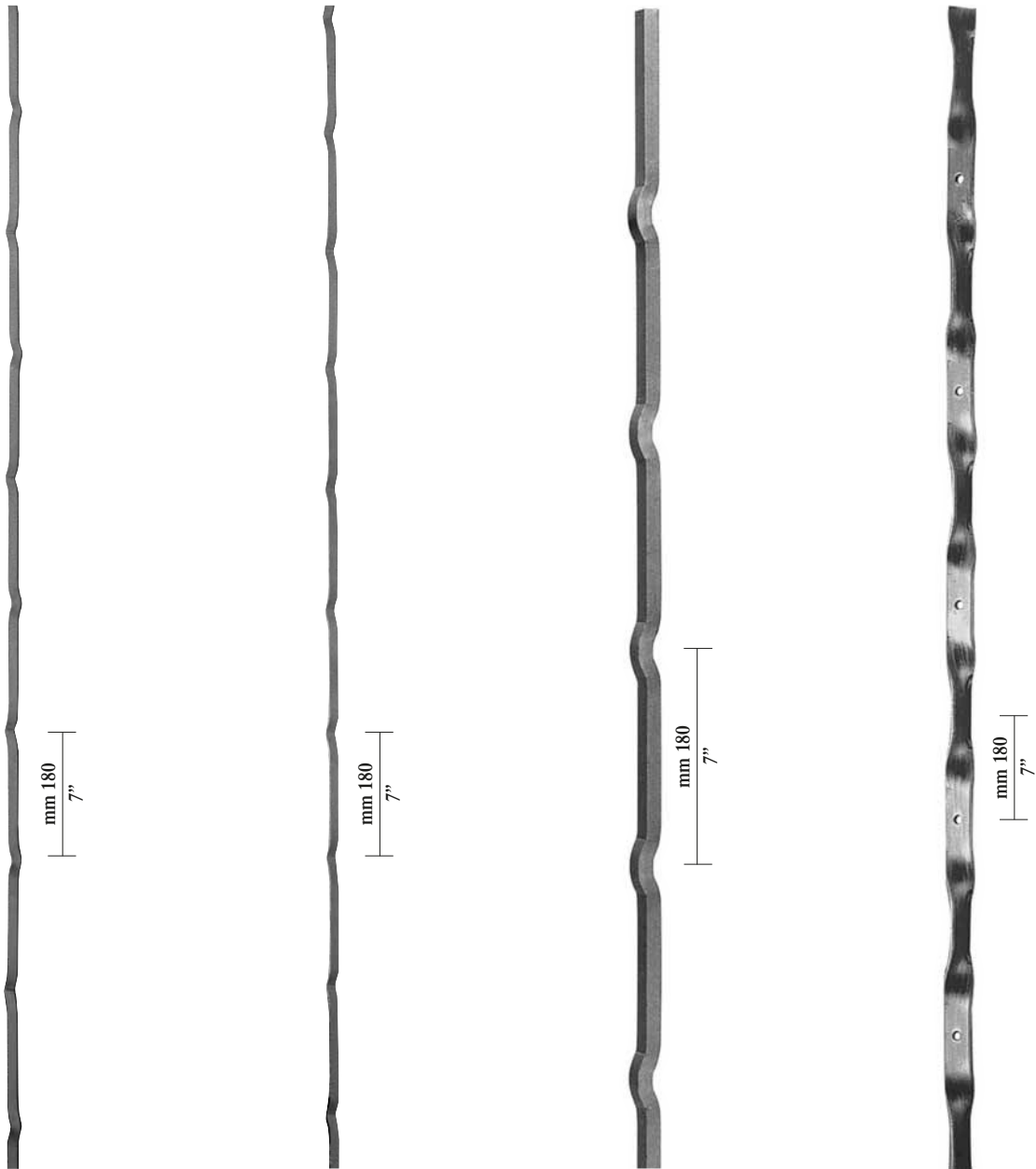

■ 14 9/16"					■ 14 9/16"					■ 14 9/16"					■ 25 x 5 1"x 3/16" ○ 8 5/16"				
7001	↔ 180	7"	4000 h	157-1/2" h	7005	↔ 180	7"	4000 h	157-1/2" h	7010	↔ 180	7"	4000 h	157-1/2" h	7012	↔ 180	7"	3000 h	118" h
7002	↔ 180	7"	2000 h	78-3/4" h	7006	↔ 180	7"	2000 h	78-3/4" h	7011	↔ 180	7"	2000 h	78-3/4" h	+10208				

■ Ferro pieno quadro
Square iron

■ Ferro pieno piatto
Flat iron

● Ferro pieno tondo
Round iron

Art. 7014-226B

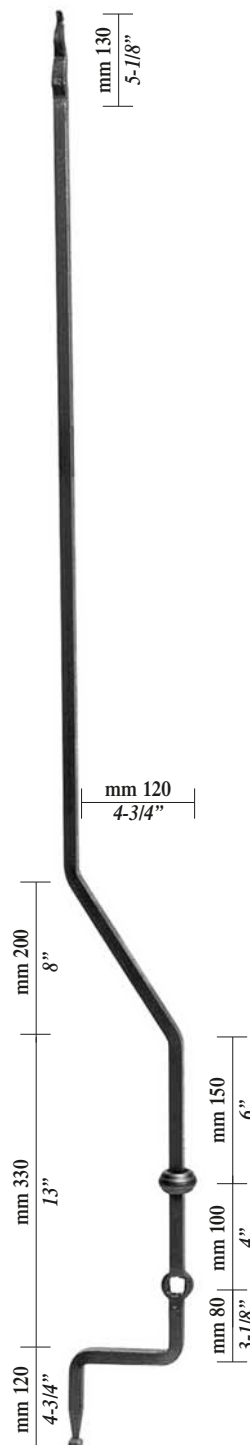
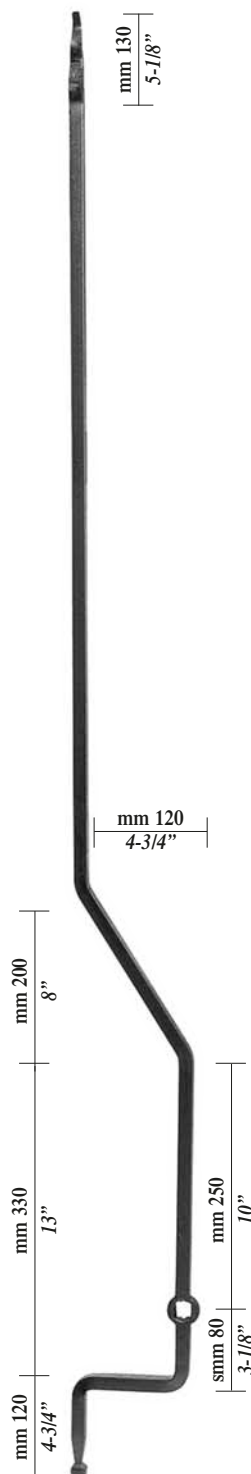

mm 2000 h 78-3/4" h				mm 2000 h 78-3/4" h				■ 14 9/16"				■ 14 9/16"			
7013	■ 14	9/16"	↔125	4-7/8"	7014-226B	▲	■ 14	9/16"	7015	M.R.		7016	M.R.		
7014	▲	■ 14	9/16"	↔125	4-7/8"		↔135	5-3/8"							

○ Foro tondo
Round hole

□ Foro quadro
Square hole

● Standard
Standard

↔ Interasse
Pitch

Particolare finitura
Finish detail

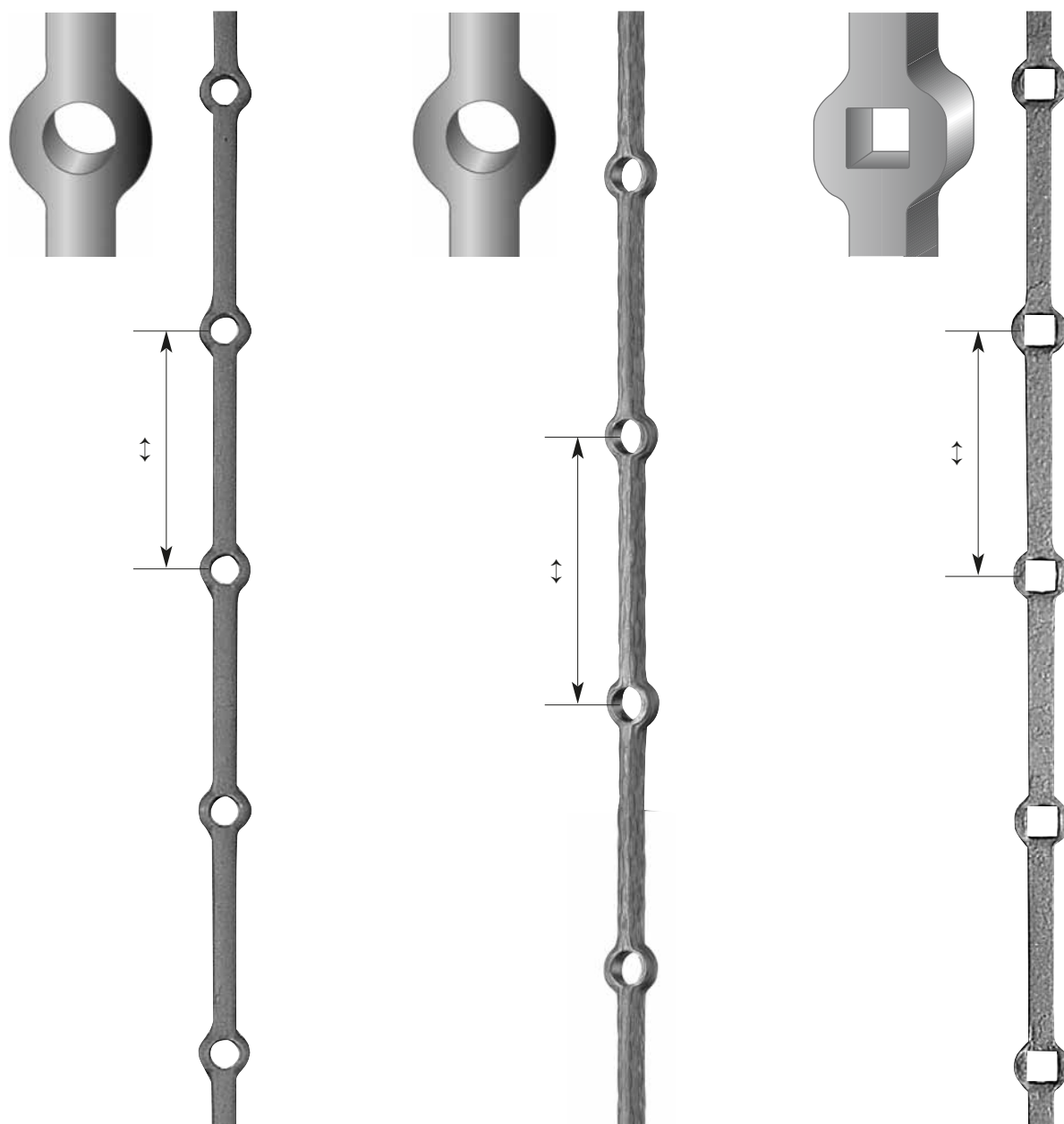

7.2

	● mm 2000 h	-	78-3/4" h	
7050-045	● 12 1/2"	↔	120 4-3/4"	N. ○ 16
7050	● 14 9/16"	↔	140 5-1/2"	N. ○ 14
7051	● 16 5/8"	↔	150 5-7/8"	N. ○ 13
7052	● 18 11/16"	↔	160 6-1/4"	N. ○ 12
7053	● 20 3/4"	↔	170 6-3/4"	N. ○ 11
7054	● 22 7/8"	↔	170 6-3/4"	N. ○ 11

	● mm 2000 h	-	78-3/4" h	
7050-045M	● 12 1/2"	↔	120 4-3/4"	N. ○ 16
7050-046M	● 14 9/16"	↔	140 5-1/2"	N. ○ 14
7050-047M	● 16 5/8"	↔	150 5-7/8"	N. ○ 13
7050-048M	● 18 11/16"	↔	160 6-1/4"	N. ○ 12
7050-049M	● 20 3/4"	↔	170 6-3/4"	N. ○ 11

	■ mm 2000 h	-	78-3/4" h	
7055-025	■ 12 1/2"	↔	120 4-3/4"	N. □ 16
7055	■ 14 9/16"	↔	140 5-1/2"	N. □ 14
7056	■ 16 5/8"	↔	150 5-7/8"	N. □ 13
7057	■ 18 11/16"	↔	160 6-1/4"	N. □ 12
7058	■ 20 3/4"	↔	170 6-3/4"	N. □ 11
7059	■ 22 7/8"	↔	170 6-3/4"	N. □ 11

■ *Ferro pieno quadro*
Square iron

■ *Ferro pieno piatto*
Flat iron

● *Ferro pieno tondo*
Round iron

7.2

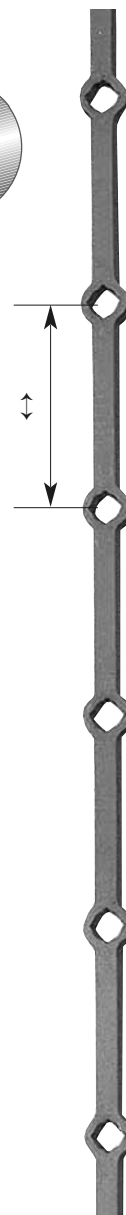
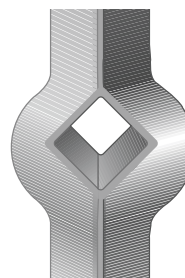
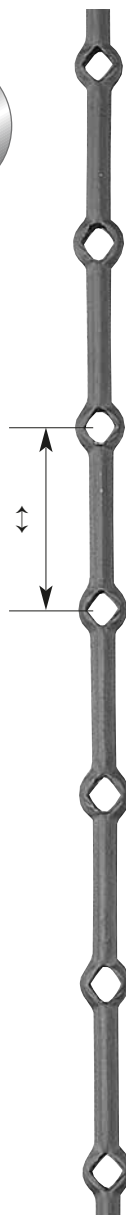
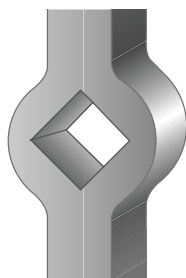
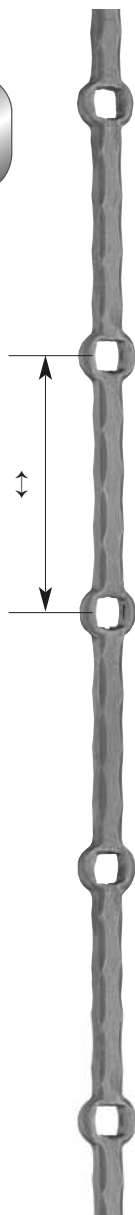
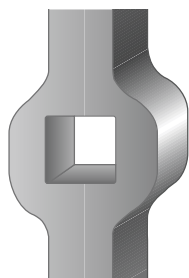

	mm	2000 h	-	78-3/4" h
7055-025B	■ 12	1/2"	↔ 120	4-3/4" N. □ 16
7055-026B	■ 14	9/16"	↔ 140	5-1/2" N. □ 14
7055-027B	■ 16	5/8"	↔ 150	5-7/8" N. □ 13
7055-028B	■ 18	11/16"	↔ 160	6-1/4" N. □ 12
7055-029B	■ 20	3/4"	↔ 170	6-3/4" N. □ 11

	mm	2000 h	-	78-3/4" h
7120	■ 14	9/16"	↔ 140	5-1/2" N. ◇ 14
7121	■ 16	5/8"	↔ 150	5-7/8" N. ◇ 13
7122	■ 18	11/16"	↔ 160	6-1/4" N. ◇ 12
7123	■ 20	3/4"	↔ 170	6-3/4" N. ◇ 11

	mm	2000 h	-	78-3/4" h
7110	■ 14	9/16"	↔ 140	5-1/2" N. ◇ 14
7111	■ 16	5/8"	↔ 150	5-7/8" N. ◇ 13
7112	■ 18	11/16"	↔ 160	6-1/4" N. ◇ 12
7113	■ 20	3/4"	↔ 170	6-3/4" N. ◇ 11



○ *Foro tondo*
Round hole

□ *Foro quadro*
Square hole

⌀ *Standard*
Standard

↔ *Interasse*
Pitch

Particolare finitura
Finish detail

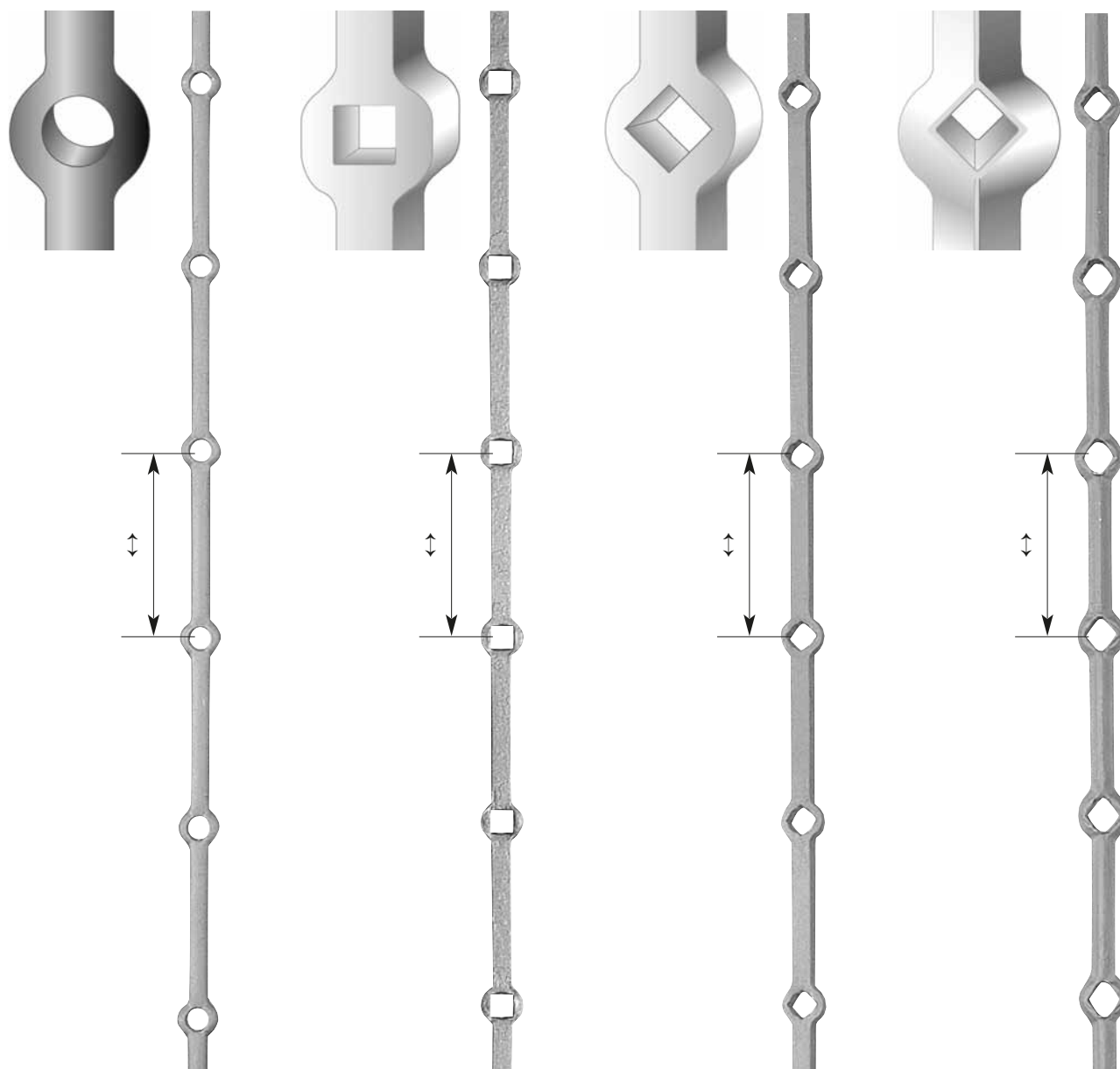

⌀ mm 2000 h - 78-3/4" h

7050-045S	● 12 1/2"
	↔120 4-3/4" N.○16
7050 001	● 14 9/16"
	↔140 5-1/2" N.○14
7051 001	● 16 5/8"
	↔150 5-7/8" N.○13
7052 001	● 18 11/16"
	↔160 6-1/4" N.○12
7053 001	● 20 3/4"
	↔170 6-3/4" N.○11
7054 001	● 22 7/8"
	↔170 6-3/4" N.○11

⌀ mm 2000 h - 78-3/4" h

7055-025S	■ 12 1/2"
	↔120 4-3/4" N.□16
7055 003	■ 14 9/16"
	↔140 5-1/2" N.□14
7056 003	■ 16 5/8"
	↔150 5-7/8" N.□13
7057 001	■ 18 11/16"
	↔160 6-1/4" N.□12
7058 001	■ 20 3/4"
	↔170 6-3/4" N.□11
7055-030S	■ 22 7/8"
	↔170 6-3/4" N.□11

⌀ mm 2000 h - 78-3/4" h

7060-026S	■ 14 9/16"
	↔140 5-1/2" N.◇14
7060-027S	■ 16 5/8"
	↔150 5-7/8" N.◇13
7060-028S	■ 18 11/16"
	↔160 6-1/4" N.◇12
7060-029S	■ 20 3/4"
	↔170 6-3/4" N.◇11

⌀ mm 2000 h - 78-3/4" h

7062-026S	■ 14 9/16"
	↔140 5-1/2" N.◇14
7062-027S	■ 16 5/8"
	↔150 5-7/8" N.◇13
7062-028S	■ 18 11/16"
	↔160 6-1/4" N.◇12
7062-029S	■ 20 3/4"
	↔170 6-3/4" N.◇11

■ Ferro pieno quadro
Square iron

■ Ferro pieno piatto
Flat iron

● Ferro pieno tondo
Round iron

Luce = Open space

7.2

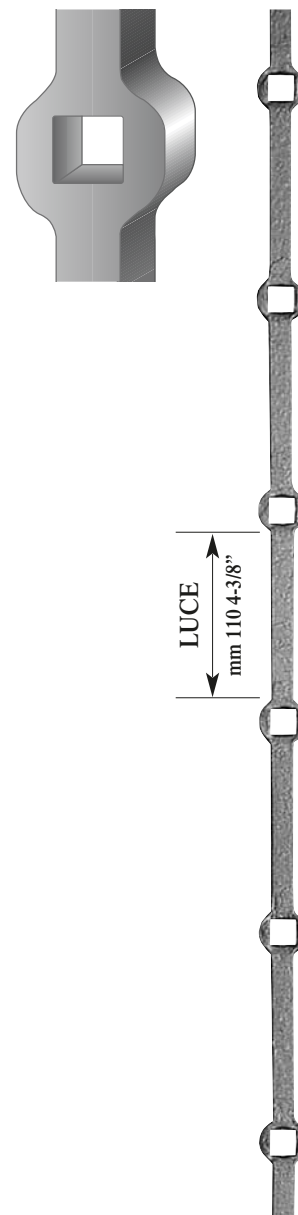
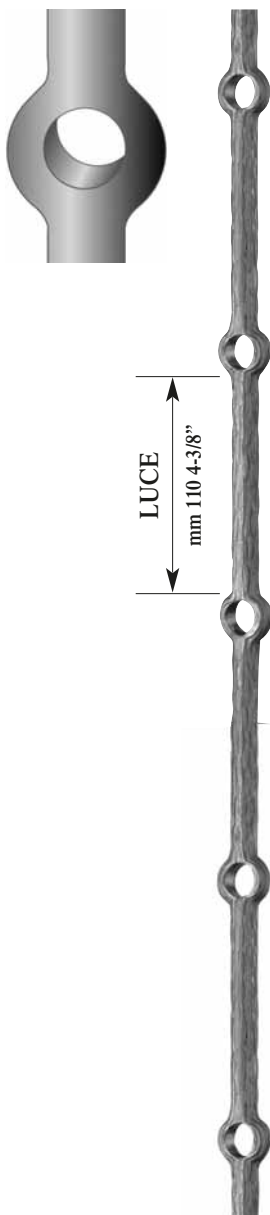
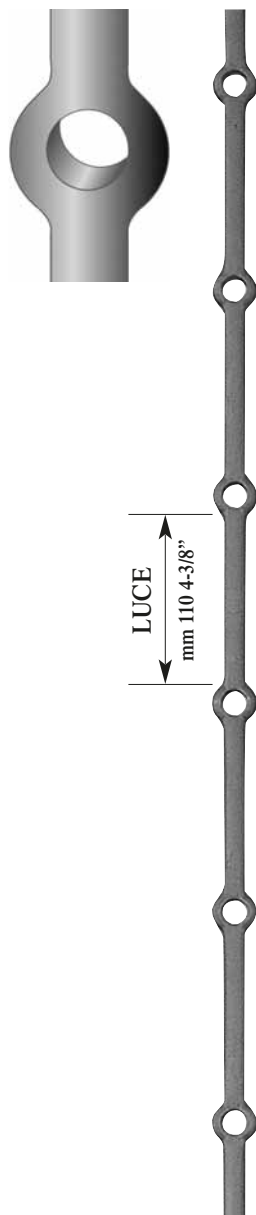

	mm 2000 h	-	78-3/4" h
7050-146	● 14 9/16"	↔ 124	4-7/8" N.○ 14
7050-147	● 16 5/8"	↔ 126	5" N.○ 14
7050-148	● 18 11/16"	↔ 128	5-1/16" N.○ 14
7050-149	● 20 3/4"	↔ 130	5-1/8" N.○ 14

	mm 2000 h	-	78-3/4" h
7050-146M	● 14 9/16"	↔ 124	4-7/8" N.○ 14
7050-147M	● 16 5/8"	↔ 126	5" N.○ 14
7050-148M	● 18 11/16"	↔ 128	5-1/16" N.○ 14
7050-149M	● 20 3/4"	↔ 130	5-1/8" N.○ 14

	mm 2000 h	-	78-3/4" h
7055-126	■ 14 9/16"	↔ 124	4-7/8" N.□ 14
7055-127	■ 16 5/8"	↔ 126	5" N.□ 14
7055-128	■ 18 11/16"	↔ 128	5-1/16" N.□ 14
7055-129	■ 20 3/4"	↔ 130	5-1/8" N.□ 14



○

Foro tondo

Round hole

□

Foro quadro

Square hole

⬮

Standard

Standard

↔

Interasse

Pitch

Particolare finitura

Finish detail

Luce = Open space

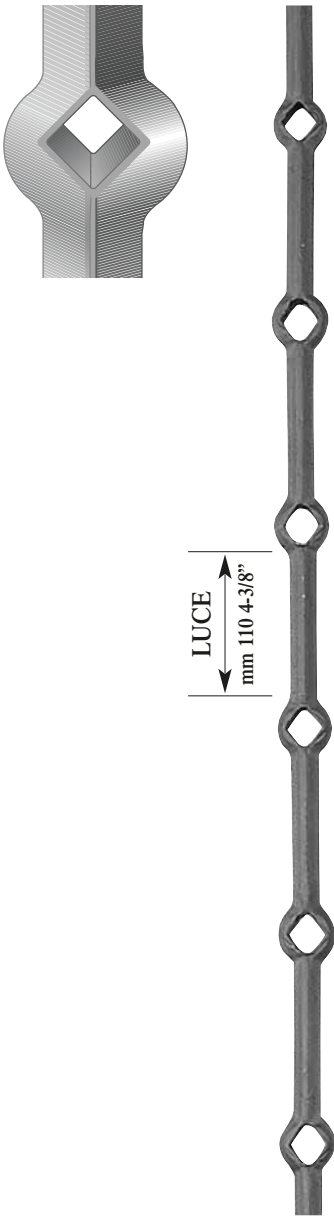
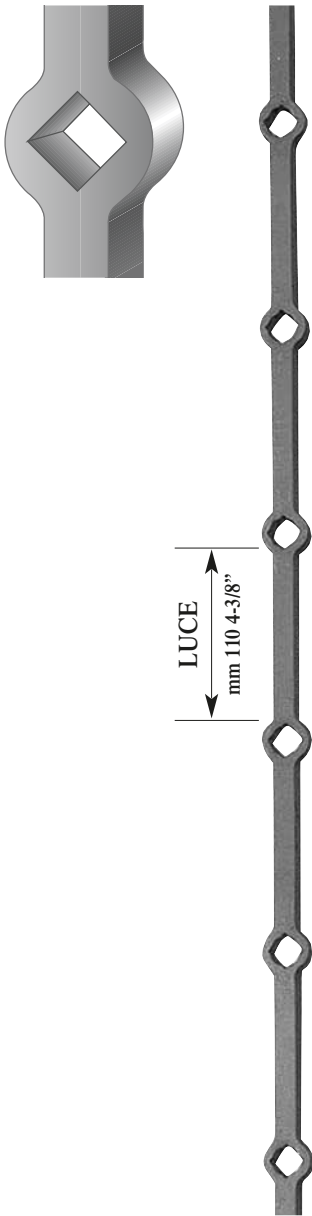

	⬮ mm 2000 h	-	78-3/4" h
7060-126	■ 14	9/16"	↔ 128 5-1/16" N:◇14
7060-127	■ 16	5/8"	↔ 130 5-1/8" N:◇14
7060-128	■ 18	11/16"	↔ 132 5-3/16" N:◇14
7060-129	■ 20	3/4"	↔ 134 5-1/4" N:◇14

	⬮ mm 2000 h	-	78-3/4" h
7062-126	■ 14	9/16"	↔ 128 5-1/16" N:◇14
7062-127	■ 16	5/8"	↔ 130 5-1/8" N:◇14
7062-128	■ 18	11/16"	↔ 132 5-3/16" N:◇14
7062-129	■ 20	3/4"	↔ 134 5-1/4" N:◇14

■ Ferro pieno quadro
Square iron

■ Ferro pieno piatto
Flat iron

● Ferro pieno tondo
Round iron

Luca = Open space

7.2

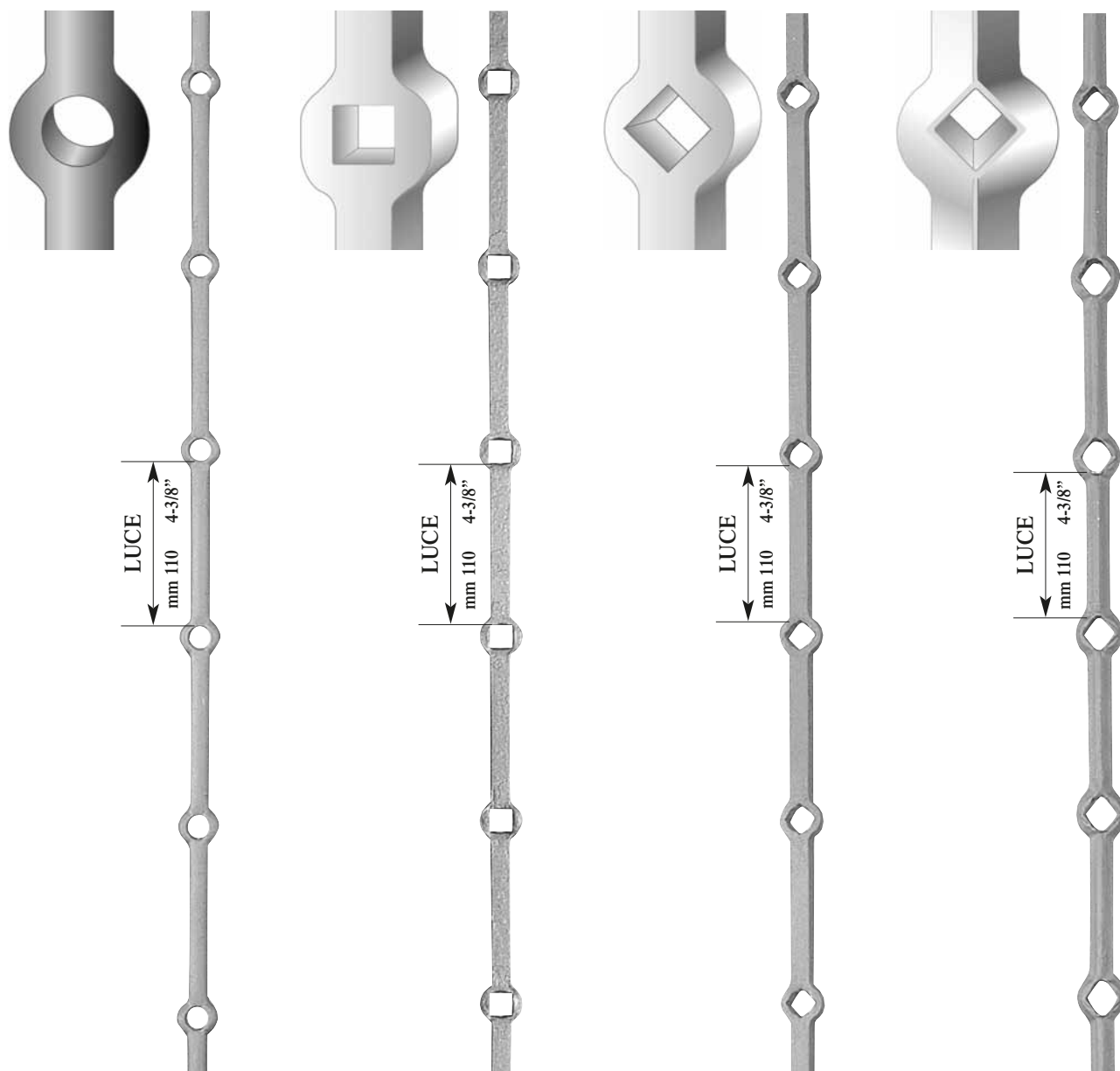

mm 2000 h - 78-3/4" h	mm 2000 h - 78-3/4" h	mm 2000 h - 78-3/4" h	mm 2000 h - 78-3/4" h
7050-146S ● 14 9/16" ↔124 4-7/8" N.○14	7055-126S ■ 14 9/16" ↔124 4-7/8" N.□14	7060-126S ■ 14 9/16" ↔128 5-1/16" N.◇14	7062-126S ■ 14 9/16" ↔128 5-1/16" N.◇14
7050-147S ● 16 5/8" ↔126 5" N.○14	7055-127S ■ 16 5/8" ↔126 5" N.□14	7060-127S ■ 16 5/8" ↔130 5-1/8" N.◇14	7062-127S ■ 16 5/8" ↔130 5-1/8" N.◇14
7050-148S ● 18 11/16" ↔128 5-1/16" N.○14	7055-128S ■ 18 11/16" ↔128 5-1/16" N.□14	7060-128S ■ 18 11/16" ↔132 5-3/16" N.◇14	7062-128S ■ 18 11/16" ↔132 5-3/16" N.◇14
7050-149S ● 20 3/4" ↔130 5-1/8" N.○14	7055-129S ■ 20 3/4" ↔130 5-1/8" N.□14	7060-129S ■ 20 3/4" ↔134 5-1/4" N.◇14	7062-129S ■ 20 3/4" ↔134 5-1/4" N.◇14

○ Foro tondo
Round hole

□ Foro quadro
Square hole

Standard
Standard

↔ Interasse
Pitch

Particolare finitura
Finish detail

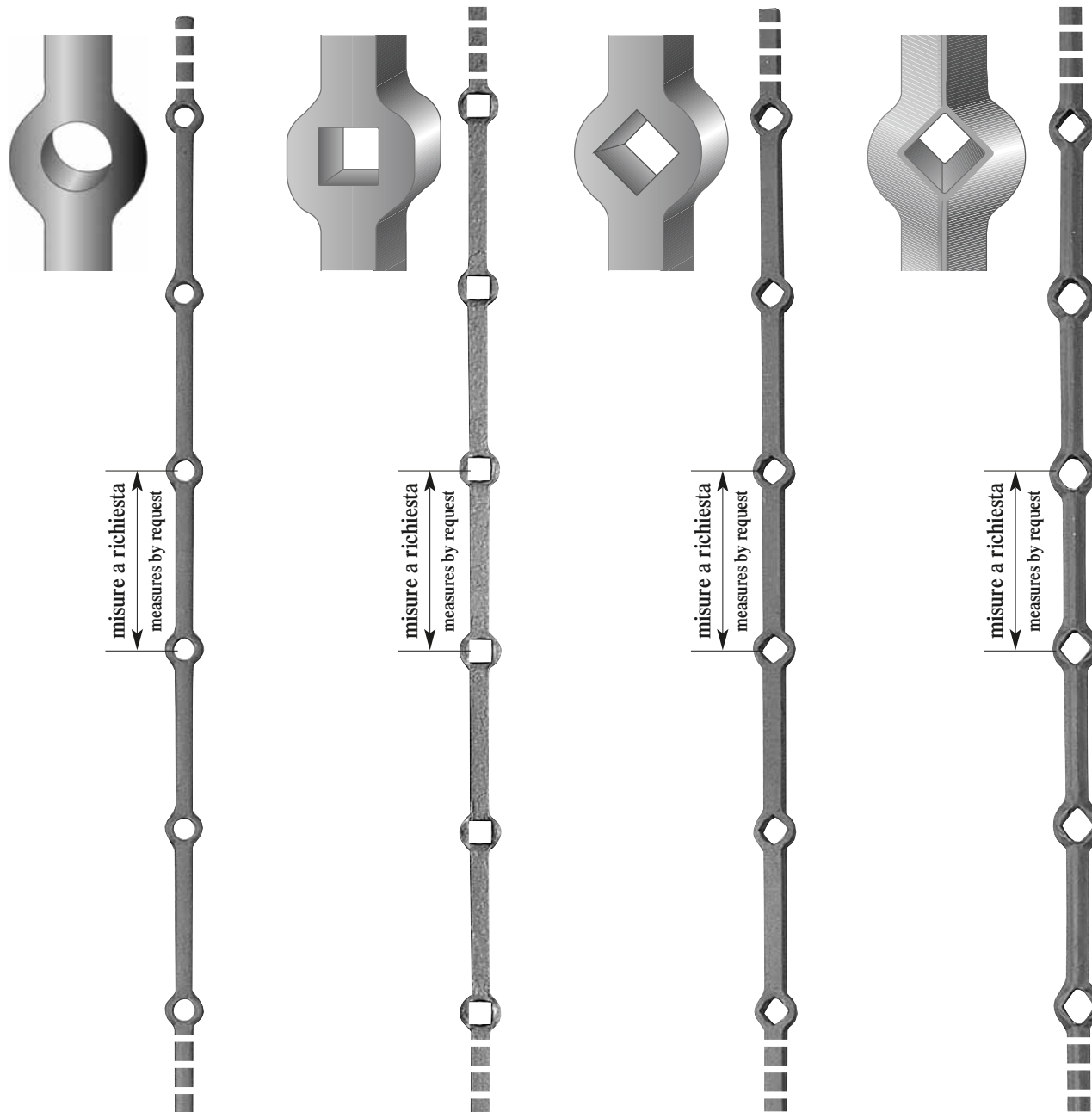

misure a richiesta - measures by request

7070	● 14	9/16"
7071	● 16	5/8"
7072	● 18	11/16"
7073	● 20	3/4"
7074	● 22	7/8"
7075	● 25	1"
7076	● 30	1- 3/16"

misure a richiesta - measures by request

7080	■ 14	9/16"
7081	■ 16	5/8"
7082	■ 18	11/16"
7083	■ 20	3/4"
7084	■ 22	7/8"
7085	■ 25	1"
7086	■ 30	1- 3/16"

misure a richiesta - measures by request

7090	■ 14	9/16"
7091	■ 16	5/8"
7092	■ 18	11/16"
7093	■ 20	3/4"

misure a richiesta - measures by request

7095	■ 14	9/16"
7096	■ 16	5/8"
7097	■ 18	11/16"
7098	■ 20	3/4"

■ Ferro pieno quadro
Square iron

■ Ferro pieno piatto
Flat iron

● Ferro pieno tondo
Round iron

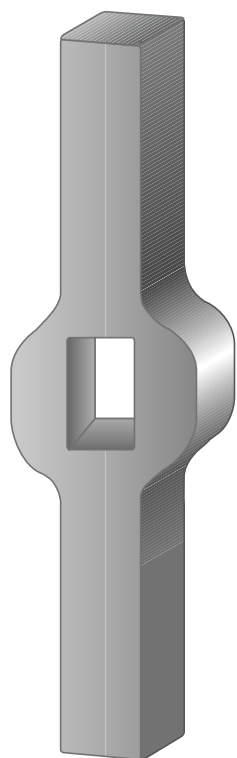

misure a richiesta - measures by request

7100	■ 14	9/16"
7101	■ 16	5/8"
7102	■ 18	11/16"
7103	■ 20	3/4"

misure a richiesta - measures by request

7105	● 14	9/16"
7106	● 16	5/8"
7107	● 18	11/16"
7108	● 20	3/4"

○ Foro tondo
Round hole

□ Foro quadro
Square hole

● Standard
Standard

↔ Interasse
Pitch

Particolare finitura
Finish detail

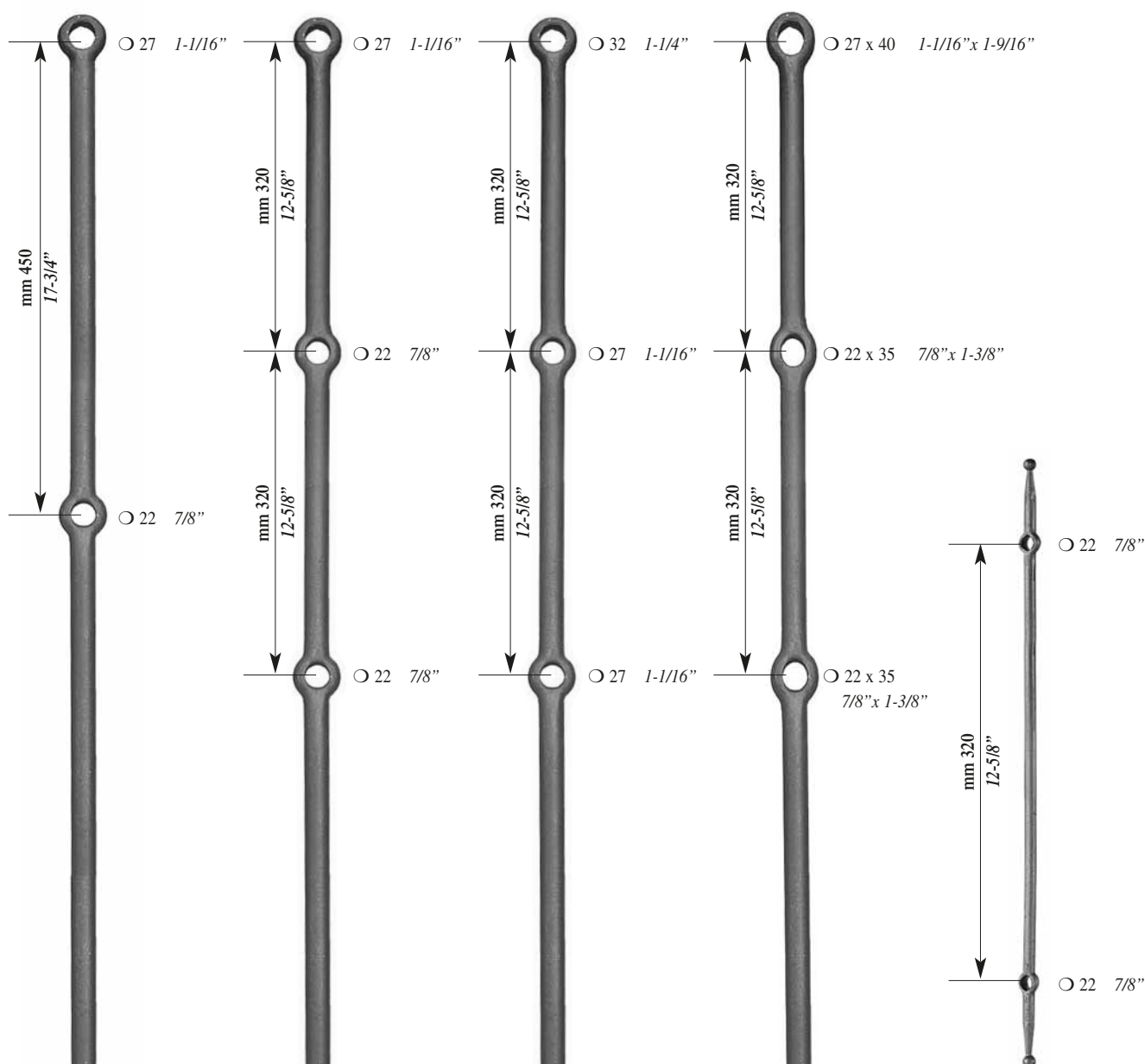

mm 1200 h 47-1/4" h
7304-051 ● 25 1"

mm 1200 h 47-1/4" h
7305 ● 25 1"

mm 1200 h 47-1/4" h
7308-052 ● 30 1-3/6"

mm 1200 h 47-1/4" h
7306-051 ● 25 1"

mm 500 h 19-5/8" h
7310-048 ● 20 3/4"

■ *Ferro pieno quadro*
Square iron

■ *Ferro pieno piatto*
Flat iron

● *Ferro pieno tondo*
Round iron

7.5

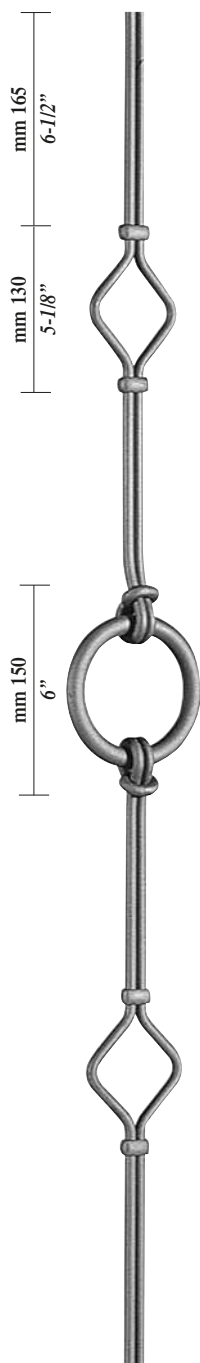

mm 115 x 1000 h
4-1/2" x 39-3/8" h

7505 ● 8 5/16"
● 14 9/16"

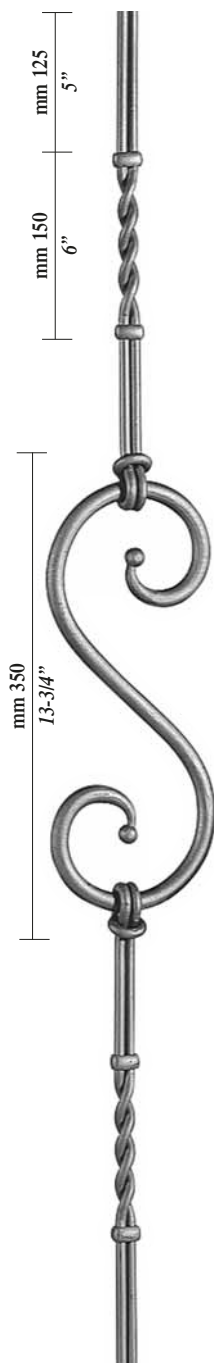

mm 135 x 1000 h
5-3/8" x 39-3/8" h

7510 ● 8 5/16"
● 14 9/16"

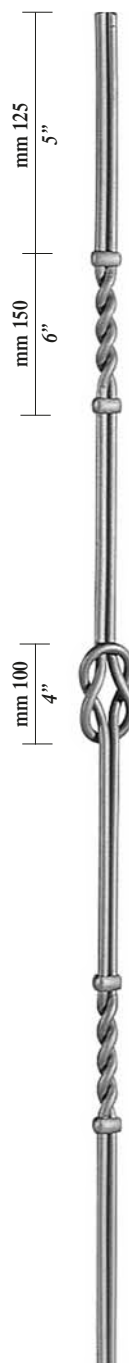

mm 50 x 1000 h
2" x 39-3/8" h

7520 ● 8 5/16"

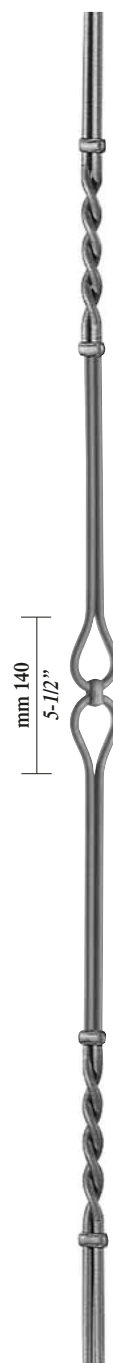



mm 45 x 1000 h
1-3/4" x 39-3/8" h

7528-043 ● 8 5/16"



 *Martellato*
Hammered

 *Rifinito a caldo*
Hot finished

 *Fascettato*
With collars

Particolare finitura
Finish detail

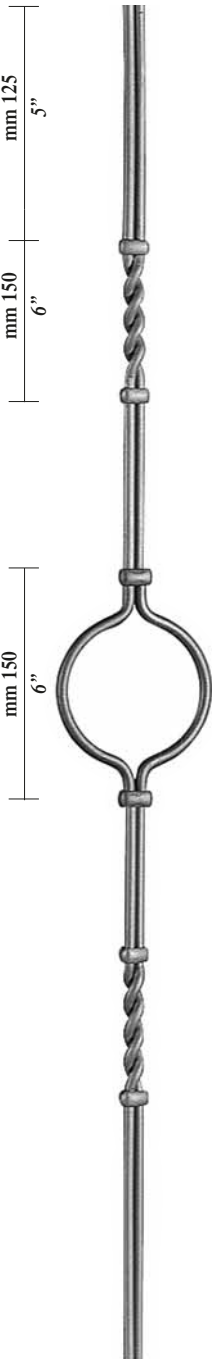

mm 105 x 1000 h
4-1/8"x 39-3/8" h
7530 ● 8 5/16"

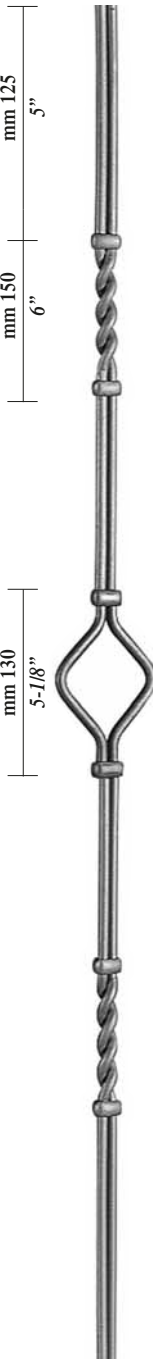

mm 80 x 1000 h
3-1/8"x 39-3/8" h
7535 ● 8 5/16"



mm 1000 h
39-3/8" h
7550 ● 8 5/16"



mm 1000 h
39-3/8" h
7555 ● 8 5/16"





■ *Ferro pieno quadro*
Square iron

■ *Ferro pieno piatto*
Flat iron

● *Ferro pieno tondo*
Round iron

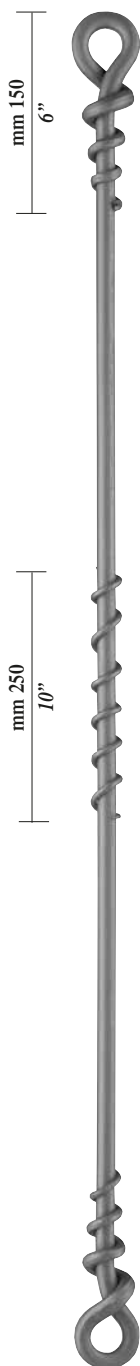
○ 22 7/8"



mm 50 x 1000 h
2"x 39-3/8" h
7700  ● 12 1/2"



mm 50 x 1000 h
2"x 39-3/8" h
7701  ● 12 1/2"



mm 50 x 1000 h
2"x 39-3/8" h
7706  ● 12 1/2"



mm 50 x 1000 h
2"x 39-3/8" h
7710  ● 12 1/2"

- *Foro tondo*
Round hole
- 🔥 *Rifinito a caldo*
Hot finished
- ✋ *Forgiato a mano*
Hand forged

Particolare finitura
Finish detail



mm 50 x 1000 h
2"x 39-3/8" h

7715 ✋ ● 12 1/2"

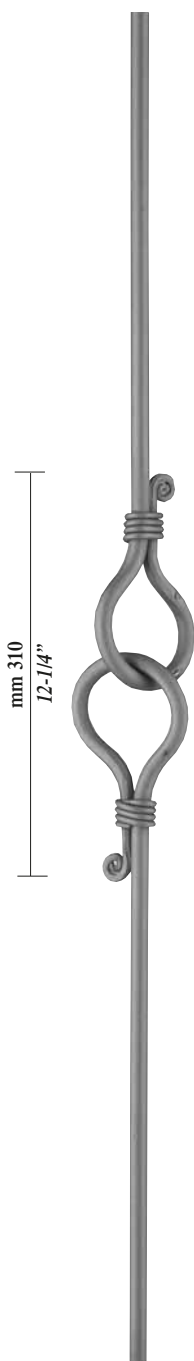

mm 90 x 1000 h
3-1/2"x 39-3/8" h

7720 ✋ ● 12 1/2"

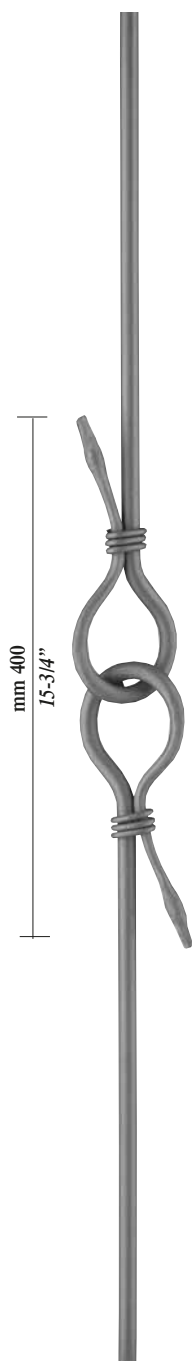

mm 80 x 1000 h
3-1/8"x 39-3/8" h

7721 ✋ ● 12 1/2"

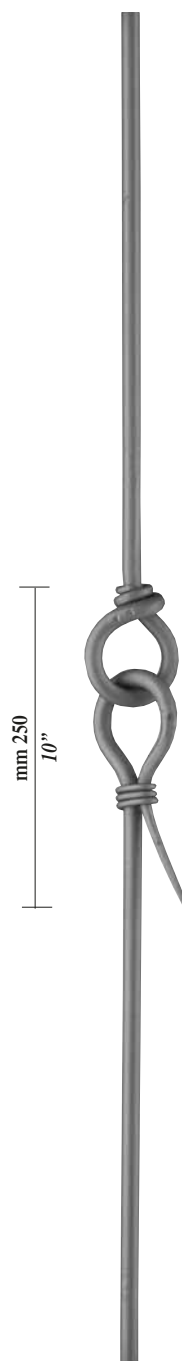

mm 70 x 1000 h
2-3/4"x 39-3/8" h

7722 ✋ ● 12 1/2"

■ *Ferro pieno quadro*
Square iron

■ *Ferro pieno piatto*
Flat iron

● *Ferro pieno tondo*
Round iron

7.7

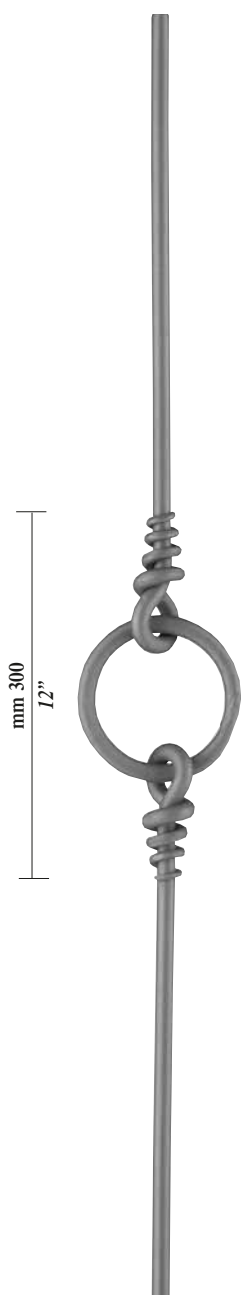

mm 130 x 1000 h
5-1/8" x 39-3/8" h
7725 ● 12 1/2"

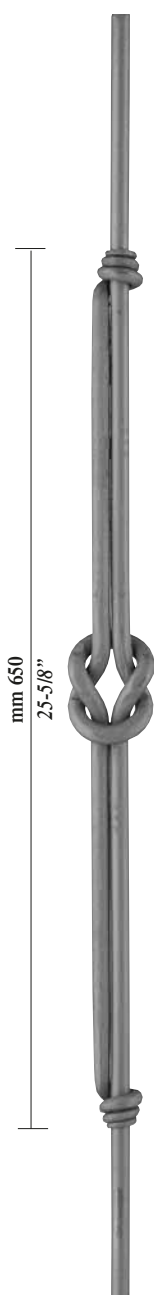

mm 60 x 1000 h
2-3/8" x 39-3/8" h
7730 ● 12 1/2"

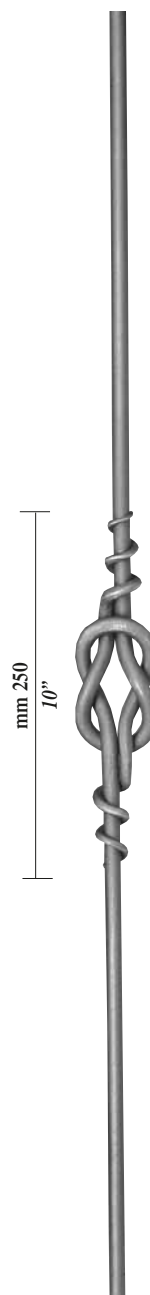

mm 60 x 1000 h
2-3/8" x 39-3/8" h
7731 ● 12 1/2"

⚒ Martellato
Hammered

🔥 Rifinito a caldo
Hot finished

✋ Forgiato a mano
Hand forged

Particolare finitura
Finish detail



mm 70
2-3/4"



mm 70
2-3/4"

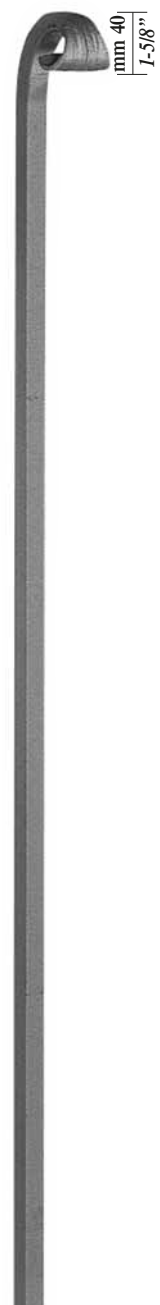

mm 100
4"

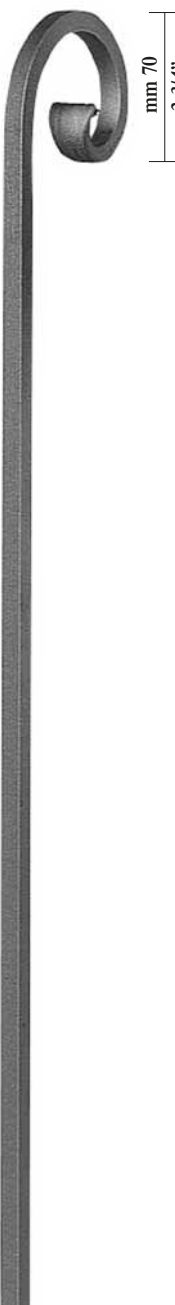

mm 100
4"



7.8

mm 70 x 1000 h 2-3/4"x 39-3/8"h

7805 ✋ ⚒ ■ 14 9/16"

mm 70 x 1500 h 2-3/4"x 59"h

7807 ✋ ⚒ ■ 16 5/8"

mm 70 x 1000 h 2-3/4"x 39-3/8"h

7810 ✋ ■ 14 9/16"

mm 70 x 1500 h 2-3/4"x 59"h

7812 ✋ ■ 16 5/8"

mm 100 x 1000 h 4"x 39-3/8"h

7815 🔥 ■ 12 1/2"

7817 🔥 ■ 14 9/16"

7821 ⚒ 🔥 ■ 12 1/2"

7823 ⚒ 🔥 ■ 14 9/16"

mm 100 x 1500 h 4"x 59" h

7819 🔥 ■ 16 5/8"

7824 ⚒ 🔥 ■ 16 5/8"

mm 100 x 1000 h 4"x 39-3/8"h

7825 🔥 ■ 12 1/2"

7826 🔥 ■ 14 9/16"

mm 100 x 1500 h 4"x 59" h

7827 🔥 ■ 16 5/8"

■ *Ferro pieno quadro*
Square iron

■ *Ferro pieno piatto*
Flat iron

● *Ferro pieno tondo*
Round iron

7.8



mm 60 x 1000 h 2-3/8"x 39-3/8"h
7830 ■ 12 1/2"

mm 70 x 1000 h 2-3/4"x 39-3/8"h
7832 ■ 14 9/16"

mm 74 x 1500h 2-15/16"x 39-3/8"h
7834 ■ 16 5/8"

mm 60 x 1000 h 2-3/8"x 39-3/8"h
7835 ■ 12 1/2"

mm 70 x 1000 h 2-3/4"x 39-3/8"h
7837 ■ 14 9/16"

mm 74 x 1500h 2-15/16"x 39-3/8"h
7839 ■ 16 5/8"

mm 60 x 1000 h 2-3/8"x 39-3/8"h
7840 ■ 12 1/2"

mm 70 x 1000 h 2-3/4"x 39-3/8"h
7842 ■ 14 9/16"

mm 74 x 1500h 2-15/16"x 39-3/8"h
7844 ■ 16 5/8"

mm 60 x 1000 h 2-3/8"x 39-3/8"h
7845 ● 12 1/2"

mm 70 x 1000 h 2-3/4"x 39-3/8"h
7847 ● 14 9/16"

mm 74 x 1500h 2-15/16"x 39-3/8"h
7849 ● 16 5/8"

⚒ Martellato
Hammered

🔥 Rifinito a caldo
Hot finished

✋ Forgiato a mano
Hand forged

Particolare finitura
Finish detail



	🔥 ■ 12	1/2"
7950	66 x 700 h	2-5/8" x 27-1/2" h
7954	66 x 900 h	2-3/4" x 35-1/2" h
	🔥 ■ 14	9/16"
7952	70 x 700 h	2-3/4" x 27-1/2" h
7956	70 x 900 h	2-3/4" x 35-1/2" h
	🔥 ■ 16	5/8"
7958	74 x 1200 h	2-15/16" x 47-1/4" h

	🔥 ■ 12	1/2"
7960	66 x 700 h	2-5/8" x 27-1/2" h
7964	66 x 900 h	2-3/4" x 35-1/2" h
	🔥 ■ 14	9/16"
7962	70 x 700 h	2-3/4" x 27-1/2" h
7966	70 x 900 h	2-3/4" x 35-1/2" h
	🔥 ■ 16	5/8"
7968	74 x 1200 h	2-15/16" x 47-1/4" h

	⚒ 🔥 ■ 12	1/2"
7970	66 x 700 h	2-5/8" x 27-1/2" h
7974	66 x 900 h	2-3/4" x 35-1/2" h
	⚒ 🔥 ■ 14	9/16"
7972	70 x 700 h	2-3/4" x 27-1/2" h
7976	70 x 900 h	2-3/4" x 35-1/2" h
	⚒ 🔥 ■ 16	5/8"
7978	74 x 1200 h	2-15/16" x 47-1/4" h

	🔥 ● 14	9/16"
7980	70 x 700 h	2-3/4" x 27-1/2" h
7982	70 x 900 h	2-3/4" x 35-1/2" h
	🔥 ● 16	5/8"
7984	74 x 1200 h	2-15/16" x 47-1/4" h

■ **Ferro pieno quadro**
Square iron

■ **Ferro pieno piatto**
Flat iron

● **Ferro pieno tondo**
Round iron

7.8

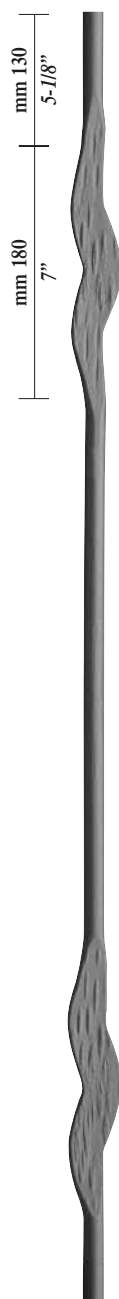
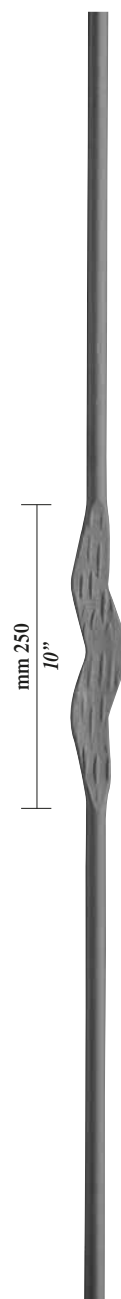
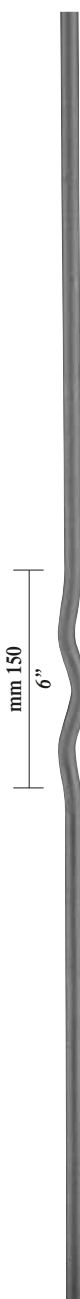

mm 60 x 1000 h 2-3/8" x 39-3/8" h	mm 35 x 1000 h 1-3/8" x 39-3/8" h	mm 1000 h 39-3/8" h	mm 1000 h 39-3/8" h	mm 1000 h 39-3/8" h	mm 1000 h 39-3/8" h
7860-025 ■ 12 1/2"	7860-045 ● 12 1/2"	7861-045 ● 12 1/2" 7861-046 ● 14 9/16"	7862-045 ● 12 1/2" 7862-046 ● 14 9/16"	7864-045 ● 12 1/2" 7864-046 ● 14 9/16"	7866-045 ● 12 1/2" 7866-046 ● 14 9/16"

 Martellato
Hammered

 Rifinito a caldo
Hot finished

 Forgiato a mano
Hand forged

Particolare finitura
Finish detail



mm 800 h
31-1/2" h

7870-045 ● 12 1/2"
7870-046 ● 14 9/16"

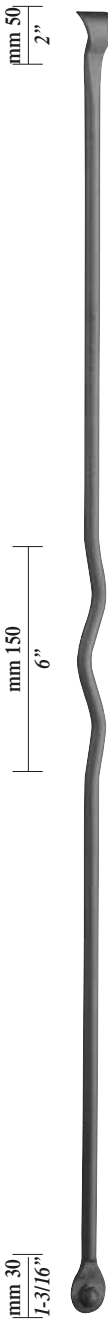

mm 800 h
31-1/2" h

7871-045 ● 12 1/2"
7871-046 ● 14 9/16"



mm 800 h
31-1/2" h

7873-045 ● 12 1/2"
7873-046 ● 14 9/16"

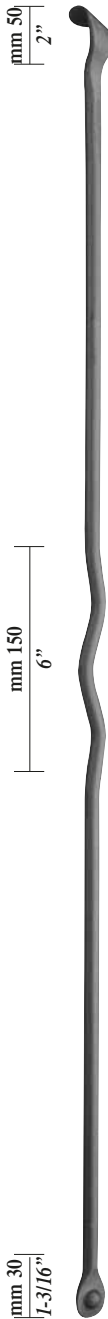

mm 800 h
31-1/2" h

7874-045 ● 12 1/2"
7874-046 ● 14 9/16"

■ **Ferro pieno quadro**
Square iron

■ **Ferro pieno piatto**
Flat iron

● **Ferro pieno tondo**
Round iron

7.8

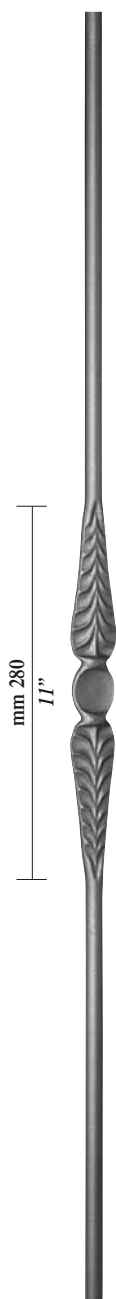

mm 1000 h
39-3/8" h

7901 ● 14 9/16"

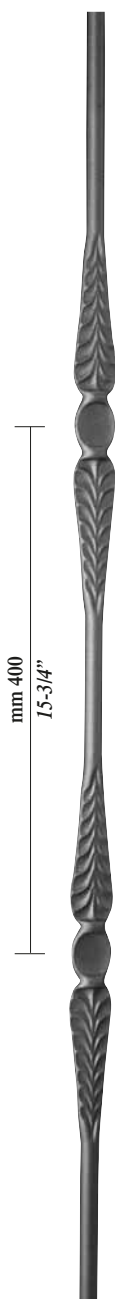

mm 1000 h
39-3/8" h

7902 ● 14 9/16"



mm 1000 h
39-3/8" h

7904 ● 14 9/16"

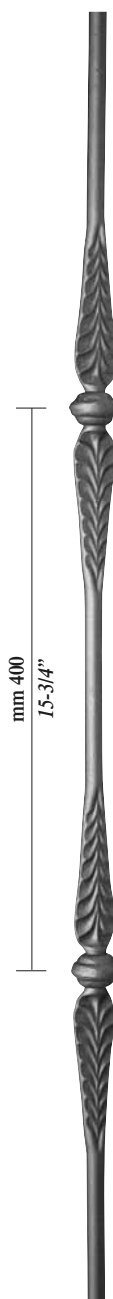

mm 1000 h
39-3/8" h

7909 ● 14 9/16"

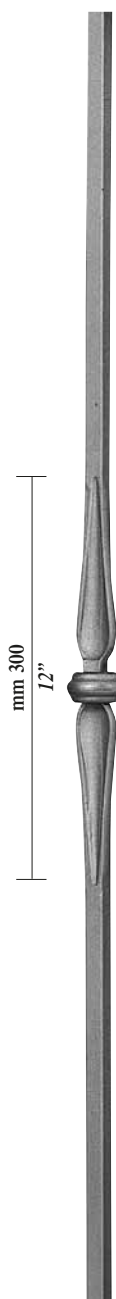

mm 1000 h
39-3/8" h

7906 ■ 14 9/16"

 *Martellato*
Hammered

 *Rifinito a caldo*
Hot finished

 *Forgiato a mano*
Hand forged

Particolare finitura
Finish detail



7.8

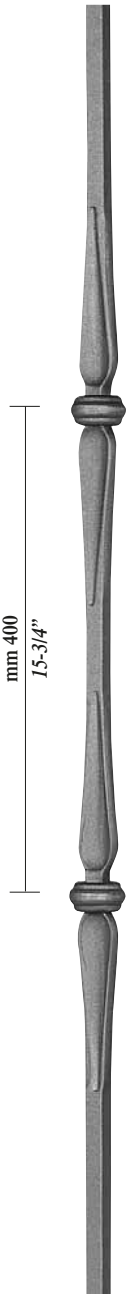

mm 400
15-3/4"

mm 1000 h
39-3/8" h

7911 ■ 14 9/16"

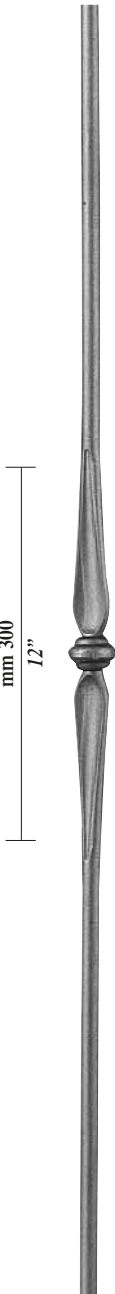

mm 300
12"

mm 1000 h
39-3/8" h

7905 ● 14 9/16"



mm 400
15-3/4"

mm 1000 h
39-3/8" h

7910 ● 14 9/16"

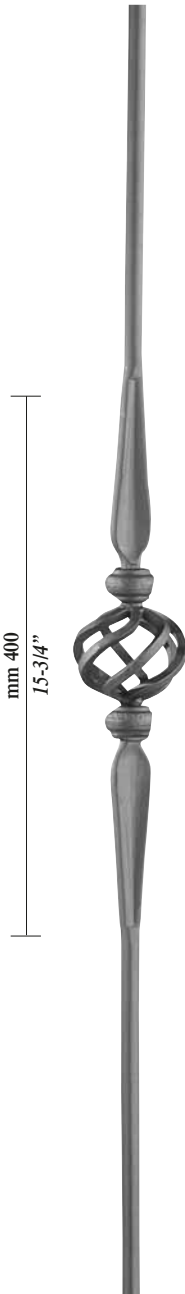

mm 400
15-3/4"

mm 70 x 1000 h
2-3/4"x 39-3/8" h

7914-046 ● 14 9/16"

■ *Ferro pieno quadro*
Square iron

■ *Ferro pieno piatto*
Flat iron

● *Ferro pieno tondo*
Round iron

7.8

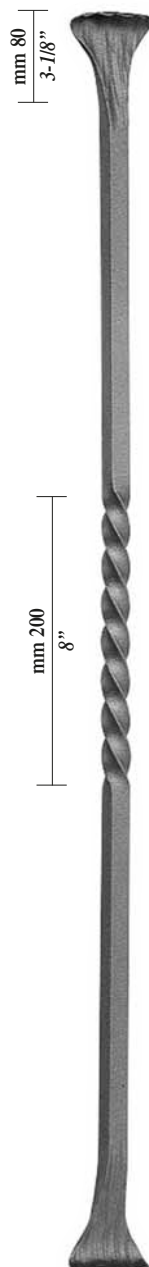
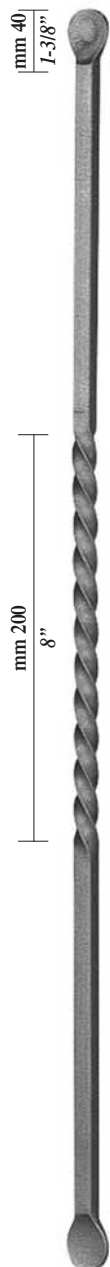



	■ 12	1/2"
7915	700 h	27-1/2" h
7917	900 h	35-1/2" h
	■ 14	9/16"
7920	700 h	27-1/2" h
7922	900 h	35-1/2" h
	■ 16	5/8"
7924	1500 h	59" h

	■ 12	1/2"
7925	700 h	27-1/2" h
7927	900 h	35-1/2" h
	■ 14	9/16"
7930	700 h	27-1/2" h
7932	900 h	35-1/2" h
	■ 16	5/8"
7935	1500 h	59" h

	■ 14	9/16"
7940	700 h	27-1/2" h
7942	900 h	35-1/2" h
	■ 16	5/8"
7944	1200 h	47-1/4" h

	■ 14	9/16"
7945	700 h	27-1/2" h
7947	900 h	35-1/2" h
	■ 16	5/8"
7949	1200 h	47-1/4" h

 *Martellato*
Hammered

 *Rifinito a caldo*
Hot finished

 *Forgiato a mano*
Hand forged

Particolare finitura
Finish detail

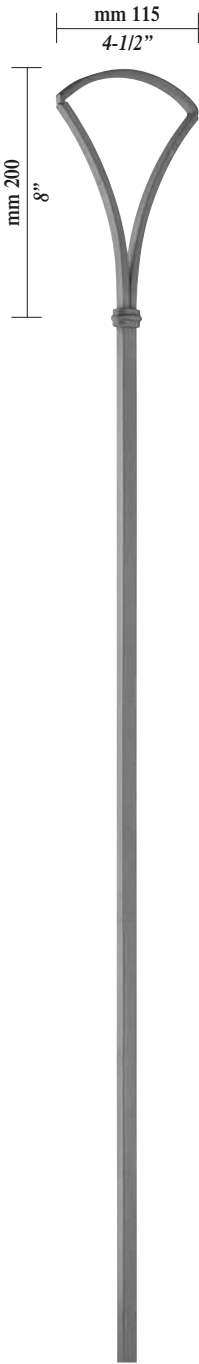

mm 115 x 1000 h
4-1/2" x 39-3/8" h
7990-025 ■ 12 1/2"



mm 115 x 1000 h
4-1/2" x 39-3/8" h
7990-125 ■ 12 1/2"



mm 115 x 1000 h
4-1/2" x 39-3/8" h
7990-225 ■ 12 1/2"



mm 115 x 1000 h
4-1/2" x 39-3/8" h
7990-325 ■ 12 1/2"



particolari che fanno la differenza • details which make the difference

7.8